

seem™ 4 led suspended

FSM4LS

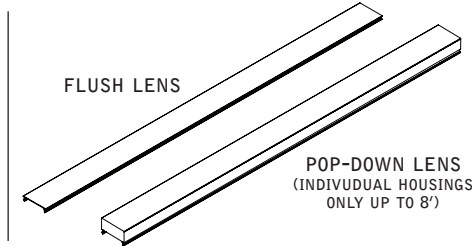

! CONFIGURATIONS ARE RUN SPECIFIC, PLEASE CONSULT FACTORY DRAWINGS BEFORE BEGINNING INSTALLATION. !

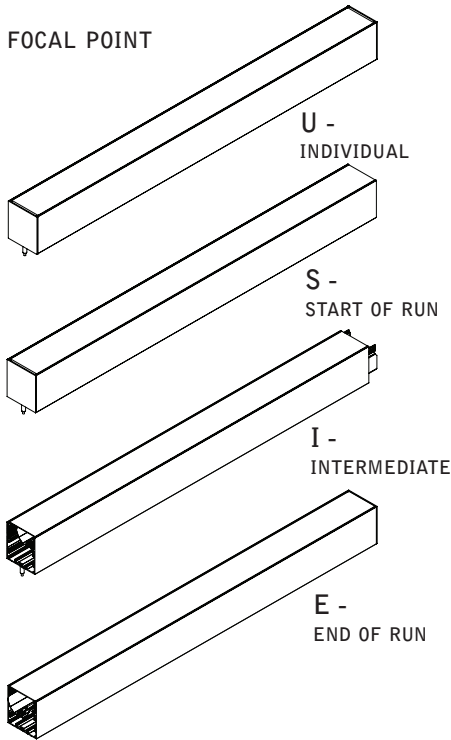

KEY

POWER OFF ATTENTION

POWER ON SEE ADDITIONAL INSTRUCTIONS

! INDIVIDUAL INSALLATIONS FOLLOW STEPS 1, 2, 5, 6, 14 & 15

PARTS LISTS

SHIPPED IN HARDWARE BAG

REFLECTOR (70008)
(6-32 X 5/16 PAN-HEAD MACHINE SCREW)

CABLE GRIPPER (73014) & NYLON NUT (70044)

LENS TOOL (A09052-02)
(AFFIXED TO HOUSING. ONE PER RUN)

SHIPPED INSTALLED

JOINER PIN (W5687)

JOINER BRACKET (18338)

LENS END PIECE (A08904)

JOINER BRACKET (11849)

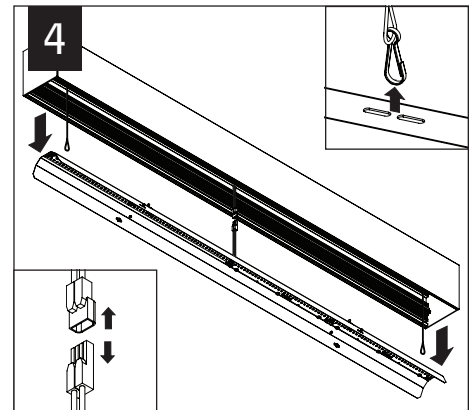
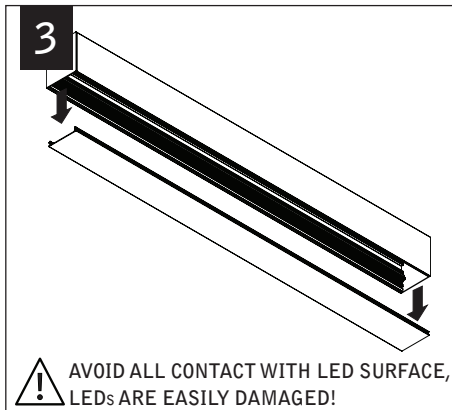
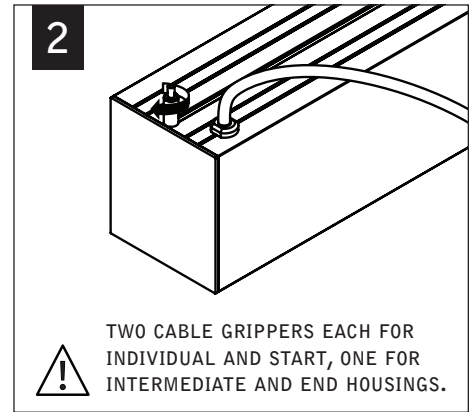
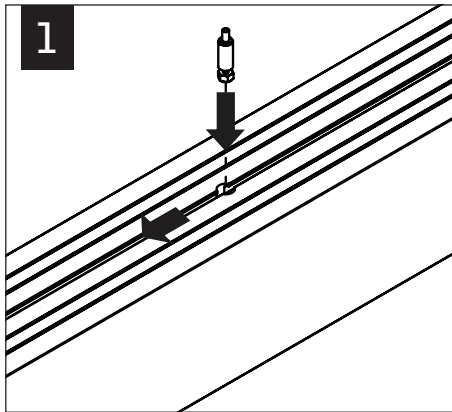

5

FOLLOW FOCAL POINT INSTRUCTIONS FOR UNIVERSAL SUSPENSION SYSTEM ASSEMBLY. SEE IS0166

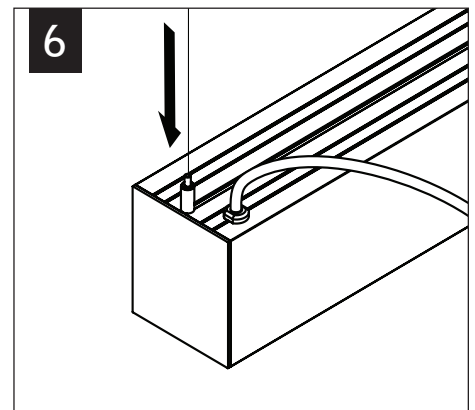

Luminaires must be installed by a qualified electrician (check with local and national codes for proper installation).
To prevent electrical shock, disconnect electrical supply before installation or servicing.

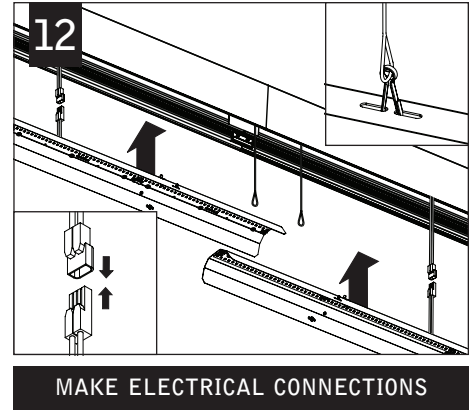
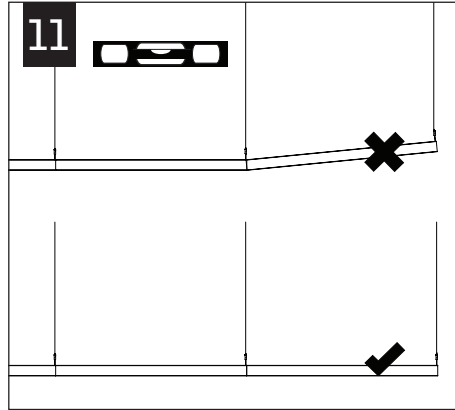
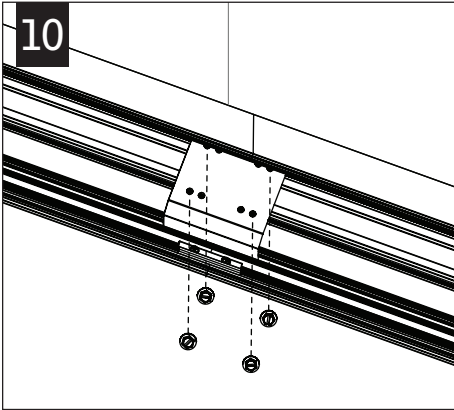
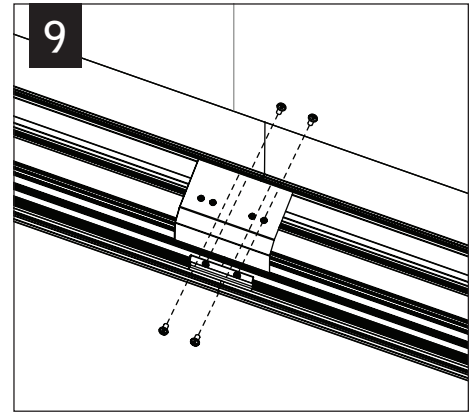
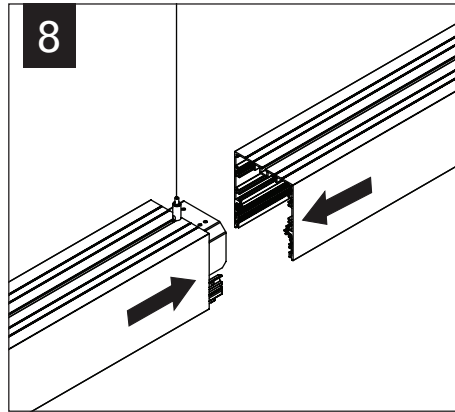
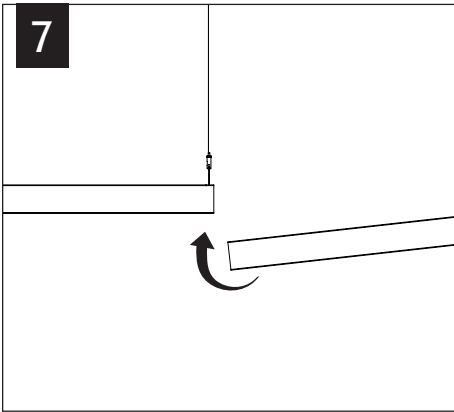

MAKE ELECTRICAL CONNECTIONS

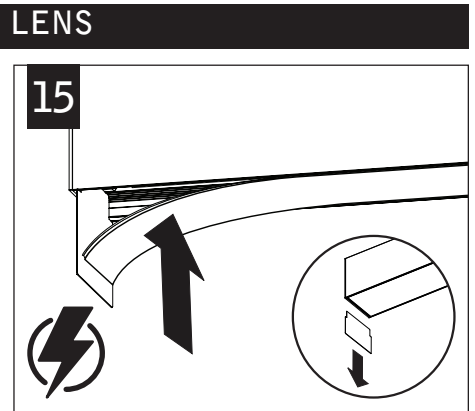
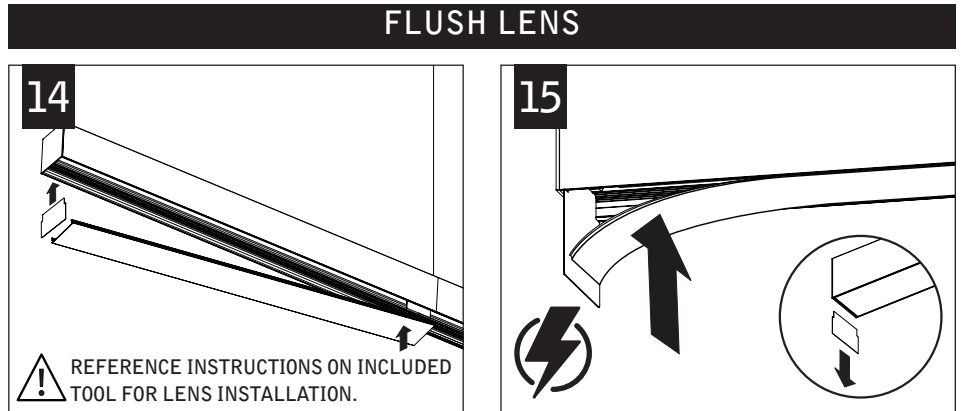
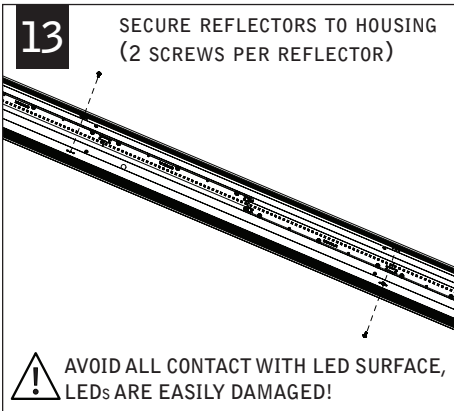

POP-DOWN LENS

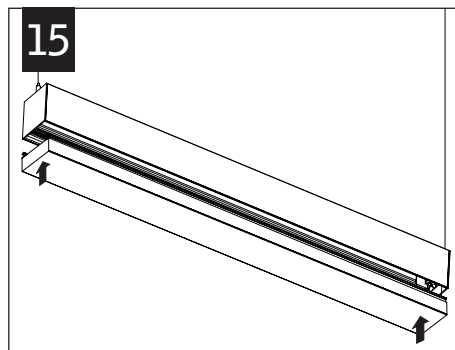
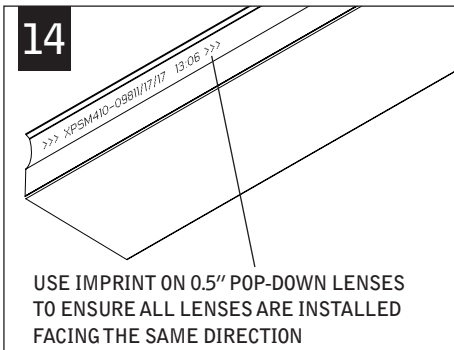

Luminaires must be installed by a qualified electrician (check with local and national codes for proper installation).
To prevent electrical shock, disconnect electrical supply before installation or servicing.

DRIVER SERVICE

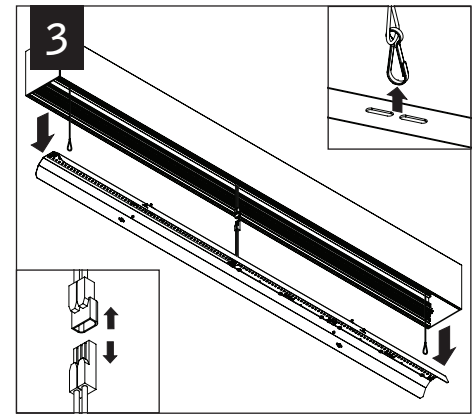
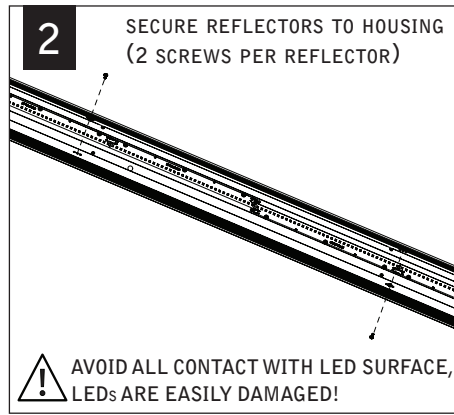
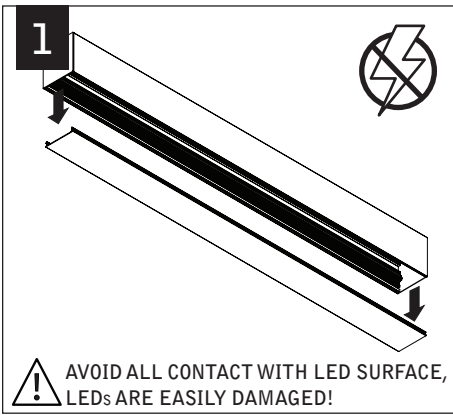

EMERGENCY



SEE BATTERY MANUFACTURER INSTRUCTIONS

EMERGENCY MAXIMUM MOUNTING HEIGHT:
19.00'

CONNECTED SOLUTIONS

ACUITY nLIGHT

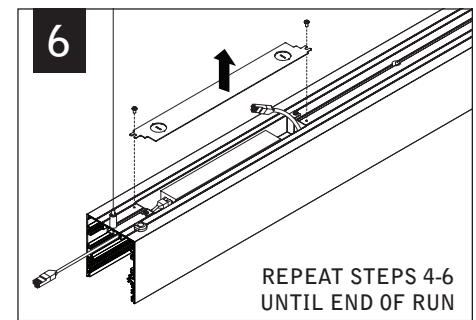
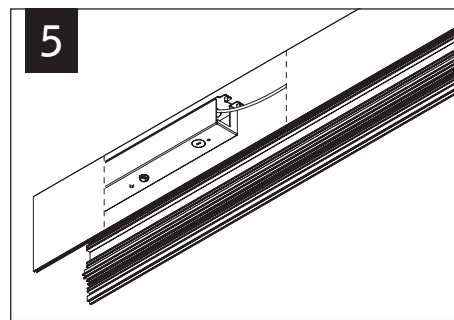
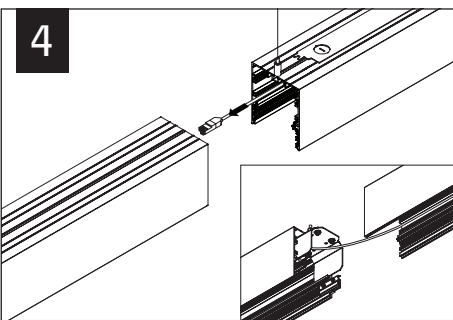
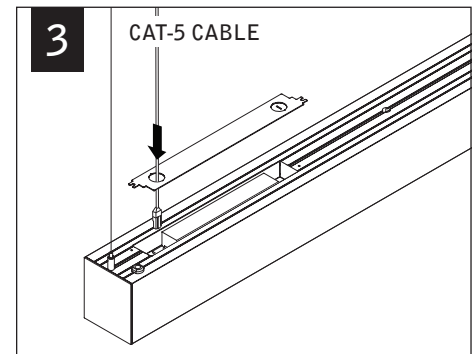
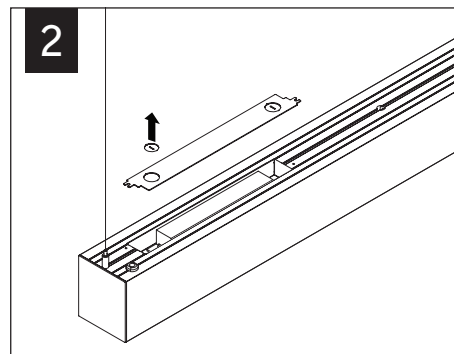
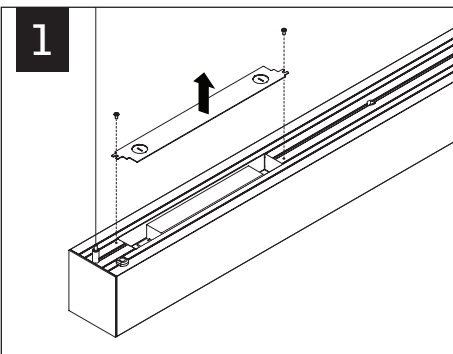

Luminaires must be installed by a qualified electrician (check with local and national codes for proper installation).
To prevent electrical shock, disconnect electrical supply before installation or servicing.

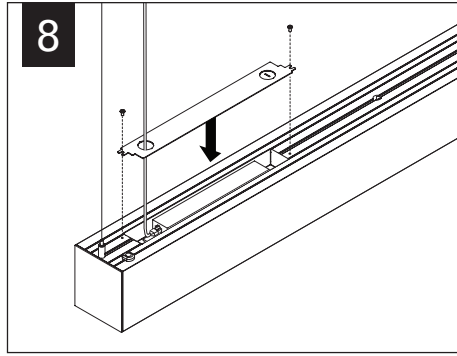
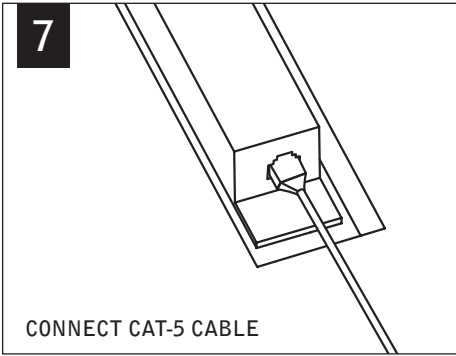

WATTSTOPPER

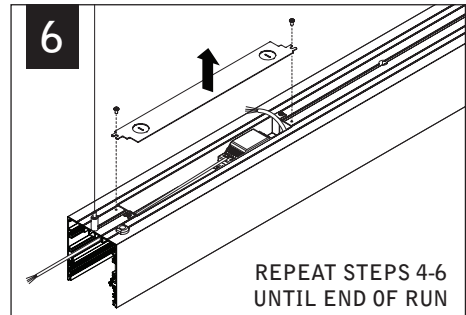
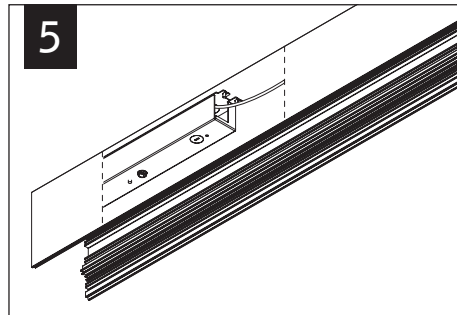
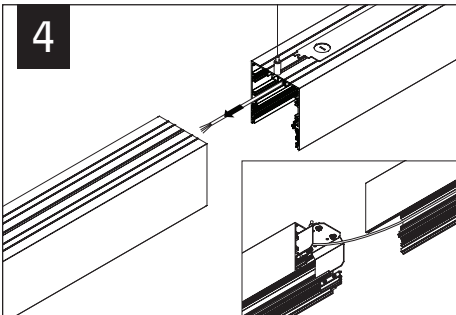
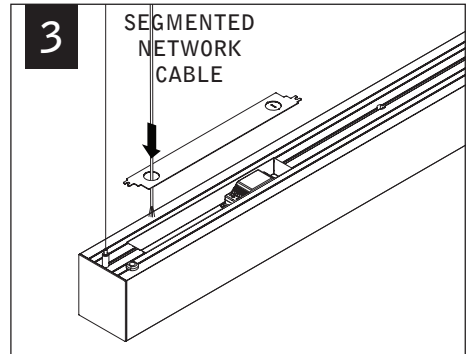
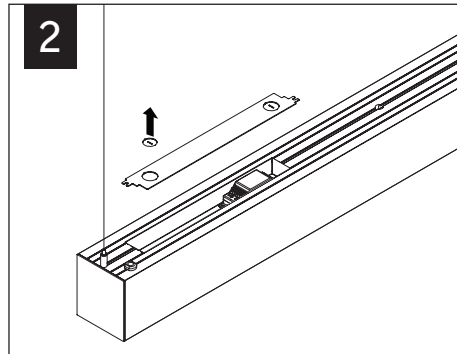
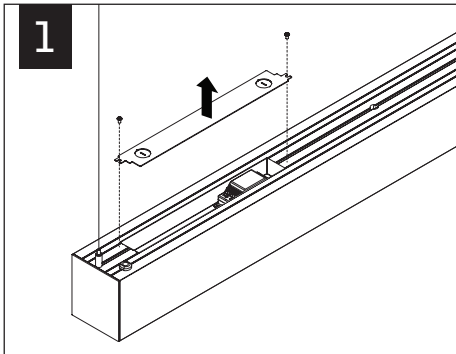

JOINED RUNS

JOINED RUNS

JOINED RUNS

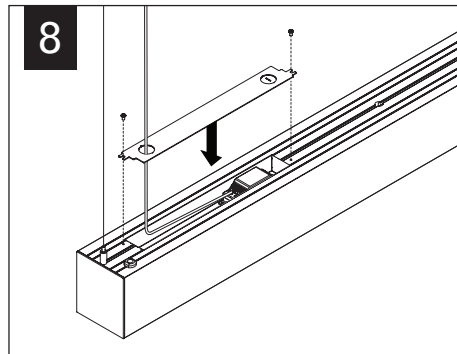
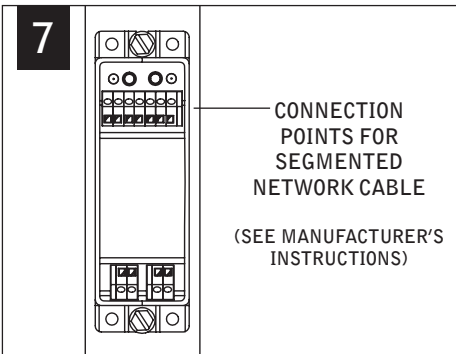

Contractor is responsible for adequately reinforcing walls and/or ceilings to support luminaire weight. Focal Point, LLC accepts no responsibility for inadequately reinforced walls and/or ceilings. The information contained in this drawing is the sole property of Focal Point, LLC. Any reproduction in part or whole without the written permission of Focal Point, LLC is prohibited.