

recessed companion

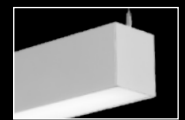

wall to ceiling companion



suspended companion

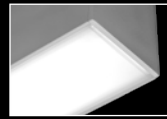

end detail

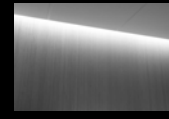

perimeter companion

## DIMENSIONAL DATA

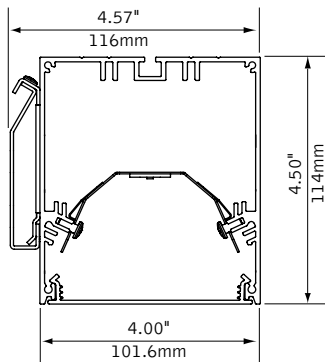

note: requires 4"x2" handy box.

## FEATURES

Narrow extruded aluminum 4" wall mount direct LED.

Individual units and continuous runs in 1' increments.

Frosted acrylic lens provides uninterrupted illumination, without pixels or shadows.

LED position and lens material optimized to provide the perfect blend of high performance and visual comfort.

Choice of output levels to meet a wide variety of application needs.

## PERFORMANCE

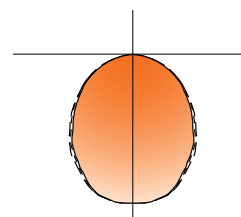

4' Flush Lens  
Nominal output:  
375 Lumens per foot

**Delivered Lumens: 1500lm**  
**Total System Watts: 15W**

### PRODUCT OVERVIEW

Lumen Output: 1500-4000lm  
Wattage: 15-46W  
LPW: 86-97  
SDCM: 3  
Reported Lumen L70 @  
Maintenance: >60,000hrs

Photometric performance is measured in accordance with IESNA LM-79.  
Visit [focalpointlights.com](http://focalpointlights.com) for complete photometric data.

fixture:

project:

## MOUNTING INFORMATION

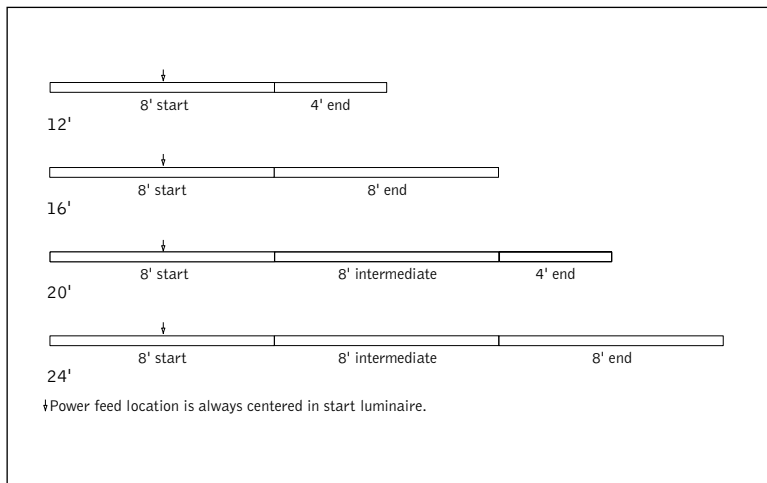

## SPECIFICATIONS

### LED System

Proprietary linear LED module incorporates premium LEDs on a robust platform to achieve excellent thermal management. LEDs are placed to promote a uniform appearance. Available in 3000K, 3500K or 4000K with CRI>80, 3SDCM. LED modules and drivers are replaceable from below.

### Construction

One piece extruded aluminum housing. Die cast aluminum end caps. 2' unit weight: 18 lbs., 3' unit weight: 24 lbs., 4' unit weight: 30 lbs., 5' unit weight: 36 lbs.

### Optic

Reflectors fabricated of 22 Ga. steel finished in High Reflectance White powder coat. Extruded acrylic lens .085" thick with satin finish, up to 8' continuous.

### Electrical

Luminaires are pre-wired with factory installed branch circuit wiring and over-molded quick connects. Standard 120-277V constant current driver includes 0-10V analog dimming. Dimming range 100% to 10%. Power factor > .9.

### Emergency Battery

Bodine BSL310-CAN. Emergency output - 10 watts for 90 minutes.

### Labels

UL and cUL listed. Suitable for Dry or Damp Locations, indoor use only.

### Finish

Polyester powder coat applied over a 5-stage pre-treatment.

### Lumen Maintenance

Calculated: L70 at 118,000 hours      Reported: L70 at >60,000 hours  
Derived from EPA TM-21 calculator based on 10,000 hours of test data.

### Warranty

LED system rated for operation in ambient environments up to 25°C. 5 year limited warranty.

## 4' PERFORMANCE CHART

Shielding	Lumens per Foot	Delivered Lumens	Tested System Watts	LWP
Flush Lens	375LF	1500	15	97
	625LF	2500	26	95
	875LF	3500	39	89
	1000LF	4000	46	86

\*Based on 3500k, 4' lengths. \*Lumen output may vary +/- 5%. Actual wattage may vary +/- 5%

## ORDERING

<b>Luminaire Series</b>	<b>FSM4LW</b>	<b>FSM4LW</b>
Seem 4 LED	FSM4LW	
<b>Shielding</b>		<b>FL</b>
Flush Satin Lens	FL	
<b>Lumen Output</b>		
275 Lumens per foot <small>(Not available with Lutron Drivers.)</small>	275LF	
375 Lumens per foot <small>(Not available with LU5 &amp; LH1 Drivers)</small>	375LF	
625 Lumens per foot <small>(3' minimum with LU5 &amp; LH1 Drivers)</small>	625LF	
875 Lumens per foot	875LF	
1000 Lumens per foot <small>(Not available with L3D driver)</small>	1000LF	
<b>Color Temperature</b>		
3000K	30K	
3500K	35K	
4000K	40K	
<b>Circuit</b>		<b>1C</b>
Single Circuit	1C	
<b>Voltage</b>		
120 Volt	120	
277 Volt	277	
UNV Volt <small>(Cannot be specified with EM option)</small>	UNV	
<b>Driver</b>		
<small>(See driver reference for driver quantities)</small>		
0-10V - 10% Dimming	LD1	
0-10V - 1% Dimming	L11	
Lutron A-Series	L3D	
1% EcoSystem Digital <small>(Consult factory for 3-wire control)</small>		
Lutron H-Series 1% Dimming	LH1	
Lutron 5-Series	LU5	
5% EcoSystem Digital		
DALI 1% Dimming	D11	
<b>Mounting</b>		<b>WM</b>
Wall Mount	WM	
<b>Factory Options</b>		
Emergency Circuit*	EC	
Emergency Battery Pack* <small>(4' lengths or longer)</small>	EM	
<b>Finish</b>		
Titanium Silver	TS	
Matte White Housing	WH	
<b>Luminaire Length*</b> <small>(Leave blank for patterns. Lengths are nominal)</small>		
Specify luminaire/row length in 1' increments <small>(Smaller increments available. Consult factory for details.)</small>	X'	
<b>Pattern Options</b> <small>(3' minimum length)</small>		
Specify luminaire/row length in 1' increments	X'	
'L' pattern <small>(Consult factory for other pattern options)</small>	A' x B'	

# Seem<sup>®</sup> 4

LED - FLUSH LENS

FSM4L-FL-1000LF-35K-1C-UNV-LD1-G1-CP-WH-4'

Filename: FSM4LFL375LF35K.IES  
Test #: 11499493.01

Lumens: 1423lm  
System Watts: 15W  
LPW: 95

## CANDLEPOWER DISTRIBUTION

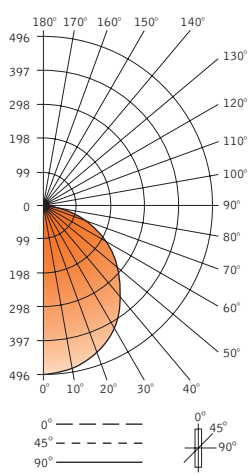

Vertical Angle	Horizontal Angle				
	0°	22.5°	45°	67.5°	90°
0°	496	496	496	496	496
5°	493	496	493	493	494
15°	475	479	475	476	477
25°	439	443	439	440	440
35°	386	390	387	387	388
45°	322	325	322	323	324
55°	253	255	253	254	254
65°	176	179	178	179	180
75°	100	102	102	104	104
85°	31	32	31	31	31
90°	0	2	2	2	2
95°	0	0	0	0	0
105°	0	0	0	0	0
115°	0	0	0	0	0
125°	0	0	0	0	0
135°	0	0	0	0	0
145°	0	0	0	0	0
155°	0	0	0	0	0
165°	0	0	0	0	0
175°	0	0	0	0	0
180°	0	0	0	0	0

## LUMEN SUMMARY

Zone	Lumens	% Fixture
0-30°	384	27.0
0-40°	627	44.1
0-60°	1103	77.5
0-90°	1423	100.00
<b>Total Luminaire 0-180°</b>	<b>1423</b>	<b>100.0</b>

## LUMINANCE DATA (CD/M<sup>2</sup>)

Vertical Angle	Horizontal		
	0°	45°	90°
45°	3757	3760	3774
55°	3634	3642	3657
65°	3441	3473	3506
75°	3193	3261	3313
85°	2923	2967	2970

Go to [www.focalpointlights.com](http://www.focalpointlights.com) for additional photometric data.