

Seem® 4

FLUORESCENT DRYWALL/HARD CEILING

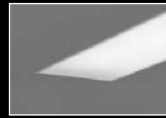

FOCAL POINT®



trimless mud-in



trim flange

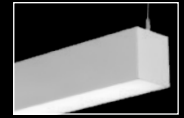

suspended companion

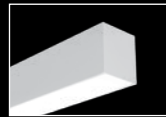

wall mount companion

DIMENSIONAL DATA

trimless mud-in

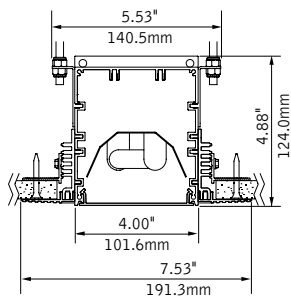

note: 0.375"min - 2.125"max ceiling thickness

non-drywall hard surface

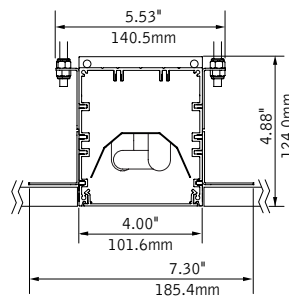

note: 0.375"min - 2.125"max ceiling thickness

trim flange

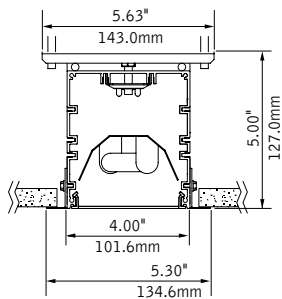

FEATURES

Narrow 4" aperture slot fluorescent luminaire that integrates with the ceiling for a clean unobtrusive aesthetic.

Frosted acrylic flush lens provides even illumination, high performance lens available for increased efficiency.

Allows for individual and continuous row mount in trimless or flanged drywall applications.

Available in T5, T5HO or T8, Seem 4 provides continuous illumination by combining 3' and 4' staggered lamps.

PERFORMANCE

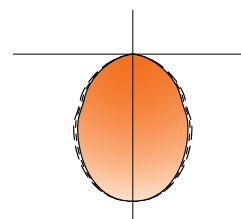

1-Lamp T5
High Performance Lens

77% Efficient

999 cd @ 0°

PRODUCT OVERVIEW

Lumen Output: 1520-3600lm

Wattage: 33-55W

Lamping: T5, T5HO, T8

1-Lamp T5
Flush Satin Lens

56% Efficient

595 cd @ 0°

Visit focalpointlights.com for complete photometric data.

fixture:

project:

SPECIFICATIONS

Construction

One piece, .07" thick housing of 6063-T5 extruded aluminum. 20 Ga. steel end caps. Luminaires include trimless aluminum flange. Lengths 6' and longer configured with staggered lamps: T8: 4.47" overlap, T5/T5HO: 4.35" overlap. 2' unit weight: 18 lbs., 3' unit weight: 24 lbs., 4' unit weight: 30 lbs., 5' unit weight: 36 lbs. Some configurations available for wood/IC applications, consult factory for details.

Optic

Reflectors fabricated of 22 Ga. steel finished in High Reflectance White powder coat. Flush satin lens: extruded acrylic lens .07" thick with opal satin finish. High performance flush lens: extruded acrylic lens .07" thick with increased light transmission. Lenses up to 8' continuous.

Electrical

Luminaires are pre-wired with factory installed branch circuit wiring and over-molded quick connects. Electronic fluorescent ballasts are thermally protected and have a Class "P" rating. Optional dimming ballasts available.

Labels

UL and cUL listed.

Finish

Polyester powder coat applied over a 5-stage pre-treatment.

ORDERING

Luminaire Series		FSM4
Seem 4	FSM4	_____
Shielding		_____
Flush Satin Lens	FL	_____
High Performance Flush Lens	FLXP	_____
<small>(Lamp image may be visible)</small>		
Lamping		_____
One Lamp T8	1T8	_____
One Lamp T5	1T5	_____
One Lamp T5HO	1T5HO	_____
Circuit		1C
Single Circuit	1C	_____
Voltage		_____
120 Volt	120	_____
277 Volt	277	_____
347 Volt	347	_____
<small>(Consult factory for dimming options)</small>		
UNV Volt	UNV	_____
<small>(Cannot be specified with 1T5HO dimming or EM options)</small>		
Ballast		_____
Electronic Program Start <10% THD	S	_____
0-10V	D7	_____
Lutron 1% 3-wire	DH	_____
Lutron 1% H-Series	DK	_____
Mounting		_____
Trim Flange Drywall	TF	_____
Mud-in Trimless, pre-set for 1/2" Drywall	XF1	_____
Mud-in Trimless, pre-set for 5/8" Drywall	XF2	_____
Mud-in Trimless, set thickness in field	XFF	_____
<small>(Mounting equipment assembled in field)</small>		
Non-Drywall Hard Surface	XFN	_____
<small>(Not intended for combustible materials) (Consult factory for wood/IC applications)</small>		
Factory Options		_____
Chicago Plenum	CP	_____
Emergency Circuit*	EC	_____
Emergency Battery Pack*	EM	_____
HLR/GLR Fuse	FU	_____
6' New York City Flex Whip	FNY	_____
6' Flex Whip	FW	_____
Include 3000K Lamp*	L830	_____
Include 3500K Lamp*	L835	_____
Include 4100K Lamp*	L841	_____
Finish		WH
Matte White Housing	WH	_____
Luminaire Length		_____
<small>(Lengths are nominal)</small>		
	2'	2'
	3'	3'
	4'	4'
	5'	5'
	6'	6'
	7'	7'
Specify row lengths 8' and longer in 4' increments	X'	_____
<small>(Lengths 6' and longer configured with staggered lamps)</small>		

Seem® 4

FLUORESCENT - HIGH PERFORMANCE FLUSH LENS

FSM4-FLXP-1T5-1C-120-S-G1-WH-4'

Filename: FSM4FLXP1T5.IES
Test #: 15712.0

Lumens: 2220lm
Efficiency: 77%

CANDLEPOWER DISTRIBUTION

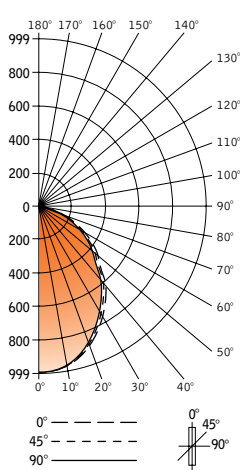

Vertical Angle	Horizontal Angle					Zonal Lumens
	0°	22.5°	45°	67.5°	90°	
0°	999	999	999	999	999	999
5°	997	996	994	994	994	95
15°	942	941	937	93	931	266
25°	831	827	817	806	802	378
35°	692	685	670	654	648	421
45°	510	503	484	466	458	375
55°	378	373	355	338	333	319
65°	236	23	219	210	205	219
75°	118	116	111	105	103	117
85°	31	29	28	28	28	31
90°	0	0	0	0	0	0
95°	0	0	0	0	0	0
105°	0	0	0	0	0	0
115°	0	0	0	0	0	0
125°	0	0	0	0	0	0
135°	0	0	0	0	0	0
145°	0	0	0	0	0	0
155°	0	0	0	0	0	0
165°	0	0	0	0	0	0
175°	0	0	0	0	0	0
180°	0	0	0	0	0	0

LUMEN SUMMARY

Zone	Lumens	% Lamp	% Fixture
0-30°	738	25.5	33.3
0-40°	1159	40.0	52.2
0-60°	1853	63.9	83.5
0-90°	2220	76.6	100
Total Luminaire 0-180°	2220	76.6	100

LUMINANCE DATA (cd/m²)

Vertical Angle	0°	45°	90°
45°	6091	5781	5470
55°	5566	5227	4903
65°	4716	7376	4097
75°	3850	3622	3361
85°	3004	2713	2713

CO-EFFICIENTS OF UTILIZATION

Floor Ceiling Wall	80				70			20		30		10		00
	70	50	30	10	70	50	10	50	10	50	10	50	10	00
RCR 0	91	91	91	91	89	89	89	85	85	81	81	78	78	77
1	85	81	78	76	82	80	75	76	72	73	70	71	68	67
2	78	72	68	64	76	71	63	68	62	66	60	64	59	58
3	72	65	59	55	70	64	54	61	53	59	53	58	52	50
4	66	58	52	47	65	57	47	55	46	54	46	52	45	44
5	61	52	46	41	59	51	41	49	40	48	40	47	39	38
6	56	47	40	36	55	46	36	45	35	44	35	42	35	33
7	52	42	35	32	51	42	32	41	31	40	31	39	31	29
8	48	38	32	8	47	38	28	37	27	36	27	35	27	26
9	45	35	28	24	43	34	24	33	24	32	24	32	24	22
10	41	31	26	22	40	31	22	30	21	30	21	29	21	20

Numbers indicate percentage values of reflectivity.

Go to www.focalpointlights.com for additional photometric data.

Seem® 4

FLUORESCENT - FLUSH LENS

FSM4-FL-1T5-1C-120-S-G1-WH-4'

Filename: FSM4FL1T5.IES
Test #: 15711.0

Lumens: 1617lm
Efficiency: 56%

CANDLEPOWER DISTRIBUTION

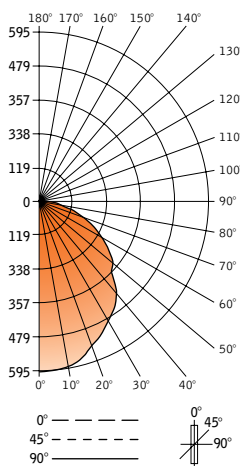

Vertical Angle	Horizontal Angle					Zonal Lumens
	0°	22.5°	45°	67.5°	90°	
0°	595	595	595	595	595	595
5°	591	591	591	591	591	56
15°	568	568	568	568	568	161
25°	515	515	515	515	515	238
35°	455	455	455	455	455	286
45°	353	355	355	355	355	275
55°	288	288	288	290	290	259
65°	198	196	198	198	199	196
75°	108	109	109	109	109	115
85°	28	28	28	28	29	31
90°	0	0	0	0	0	0
95°	0	0	0	0	0	0
105°	0	0	0	0	0	0
115°	0	0	0	0	0	0
125°	0	0	0	0	0	0
135°	0	0	0	0	0	0
145°	0	0	0	0	0	0
155°	0	0	0	0	0	0
165°	0	0	0	0	0	0
175°	0	0	0	0	0	0
180°	0	0	0	0	0	0

LUMEN SUMMARY

Zone	Lumens	% Lamp	% Fixture
0-30°	456	15.7	28.2
0-40°	742	25.6	45.9
0-60°	1275	44.0	78.9
0-90°	1617	55.8	100
Total Luminaire 0-180°	1617	55.8	100

LUMINANCE DATA (cd/m²)

Vertical Angle	0°	45°	90°
45°	4216	4240	4240
55°	4241	4241	4270
65°	3957	3957	3977
75°	3524	3557	3557
85°	2713	2713	2810

CO-EFFICIENTS OF UTILIZATION

Floor Ceiling Wall	80				70			20		30		10		00
	70	50	30	10	70	50	10	50	10	50	10	50	10	00
RCR 0	66	66	66	66	65	65	65	62	62	59	59	57	57	56
1	61	59	56	54	60	57	53	55	52	53	50	51	49	48
2	56	52	48	45	54	51	44	49	43	47	42	45	41	40
3	51	46	41	38	50	45	38	43	37	42	36	40	36	35
4	47	41	36	32	46	40	32	39	32	37	31	36	31	30
5	43	36	31	27	42	35	27	34	27	33	27	32	26	25
6	40	32	27	24	39	32	24	31	23	30	23	29	23	22
7	36	29	24	21	36	29	21	28	21	27	20	26	20	19
8	34	26	21	18	33	26	18	25	18	24	18	24	18	17
9	31	23	19	16	30	23	16	22	15	22	15	21	15	14
10	29	21	17	14	28	21	14	20	14	20	14	19	14	13

Numbers indicate percentage values of reflectivity.

Go to www.focalpointlights.com for additional photometric data.

Seem® 4

FLUORESCENT - HIGH PERFORMANCE FLUSH LENS

FSM4-FLXP-1T8-1C-120-S-TF-WH-4'

Filename: FSM4FLXP1T8.IES
Test #: 15815.0

Lumens: 2114lm
Efficiency: 72%

CANDLEPOWER DISTRIBUTION

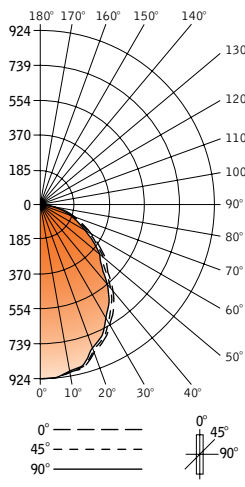

Vertical Angle	Horizontal Angle					Zonal Lumens
	0°	22.5°	45°	67.5°	90°	
0°	924	924	924	924	924	924
5°	922	920	920	920	920	88
15°	890	886	883	881	877	250
25°	791	787	778	767	762	360
35°	667	659	645	630	623	405
45°	490	481	464	448	442	360
55°	360	355	342	328	320	306
65°	222	218	207	200	195	207
75°	113	109	103	100	100	111
85°	29	27	25	23	23	28
90°	0	0	0	0	0	0
95°	0	0	0	0	0	0
105°	0	0	0	0	0	0
115°	0	0	0	0	0	0
125°	0	0	0	0	0	0
135°	0	0	0	0	0	0
145°	0	0	0	0	0	0
155°	0	0	0	0	0	0
165°	0	0	0	0	0	0
175°	0	0	0	0	0	0
180°	0	0	0	0	0	0

LUMEN SUMMARY

Zone	Lumens	% Lamp	% Fixture
0-30°	698	23.7	33.0
0-40°	1103	37.4	52.2
0-60°	1769	60.0	83.7
0-90°	2114	71.7	100
Total Luminaire 0-180°	2114	71.7	100

LUMINANCE DATA (CD/M²)

Vertical Angle	0°	45°	90°
45°	5921	5607	5341
55°	5363	5095	4767
65°	4489	4185	3943
75°	3731	3401	3302
85°	2843	2451	2255

CO-EFFICIENTS OF UTILIZATION

	80				70				20				50				30				10				00			
	Floor	Ceiling	Wall	0	Floor	Ceiling	Wall	0	Floor	Ceiling	Wall	0	Floor	Ceiling	Wall	0	Floor	Ceiling	Wall	0	Floor	Ceiling	Wall	0	Floor	Ceiling	Wall	0
RCR 0	85	85	85	85	83	83	83	83	80	80	80	80	76	76	76	73	73	73	73	72	72	72	72	72	72	72	72	
1	79	76	74	71	77	75	70	72	68	69	66	66	64	64	62	62	60	55	54	62	64	62	64	62	64	62	64	
2	73	68	64	60	71	66	59	64	58	62	57	60	55	54	60	55	54	54	54	60	55	54	54	54	54	54	54	
3	67	61	56	51	66	60	51	58	50	56	49	54	48	47	54	48	47	47	47	54	48	47	47	47	47	47	47	
4	62	54	49	44	61	53	44	52	44	50	43	49	42	41	49	42	41	41	41	49	42	41	41	41	41	41	41	
5	57	49	43	38	56	48	38	46	38	45	37	44	37	35	44	37	35	35	35	44	37	35	35	35	35	35	35	
6	53	44	38	34	51	43	33	42	33	41	33	40	33	31	40	33	31	31	31	40	33	31	31	31	31	31	31	
7	49	40	34	30	48	39	29	38	29	37	29	36	29	27	36	29	27	27	27	36	29	27	27	27	27	27	27	
8	45	36	30	26	44	35	26	34	26	33	26	33	26	24	33	26	24	24	24	33	26	24	24	24	24	24	24	
9	42	32	27	23	41	32	23	31	22	30	22	29	22	21	29	22	21	21	21	29	22	21	21	21	21	21	21	
10	39	29	24	20	38	29	20	28	20	28	20	27	20	19	27	20	19	19	19	27	20	19	19	19	19	19	19	

Numbers indicate percentage values of reflectivity.

Go to www.focalpointlights.com for additional photometric data.

Seem® 4

FLUORESCENT - FLUSH LENS

FSM4-FL-1T8-1C-120-S-TF-WH-4'

Filename: FSM4FL1T8.IES
Test #: 15814.0

Lumens: 1520lm
Efficiency: 52%

CANDLEPOWER DISTRIBUTION

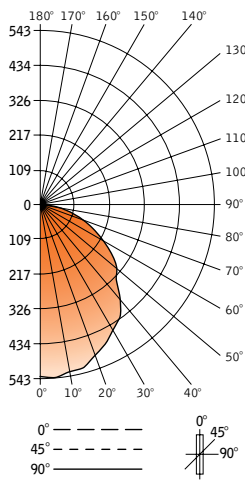

Vertical Angle	Horizontal Angle					Zonal Lumens
	0°	22.5°	45°	67.5°	90°	
0°	539	539	539	539	539	539
5°	543	543	543	543	543	52
15°	528	528	528	528	528	150
25°	484	484	484	484	484	224
35°	433	433	433	433	433	272
45°	333	333	333	333	337	258
55°	271	271	271	271	271	243
65°	182	184	184	184	185	183
75°	102	100	102	102	102	107
85°	29	29	29	29	29	32
90°	0	0	0	0	0	0
95°	0	0	0	0	0	0
105°	0	0	0	0	0	0
115°	0	0	0	0	0	0
125°	0	0	0	0	0	0
135°	0	0	0	0	0	0
145°	0	0	0	0	0	0
155°	0	0	0	0	0	0
165°	0	0	0	0	0	0
175°	0	0	0	0	0	0
180°	0	0	0	0	0	0

LUMEN SUMMARY

Zone	Lumens	% Lamp	% Fixture
0-30°	426	14.4	28.0
0-40°	698	23.6	45.9
0-60°	1199	40.6	78.9
0-90°	1520	51.5	100
Total Luminaire 0-180°	1520	51.5	100

LUMINANCE DATA (CD/M²)

Vertical Angle	0°	45°	90°
45°	4024	4024	4073
55°	4037	4037	4037
65°	3680	3720	3741
75°	3368	3368	3368
85°	2843	2843	2843

CO-EFFICIENTS OF UTILIZATION

	80				70				20				50				30				10				00			
	Floor	Ceiling	Wall	0	Floor	Ceiling	Wall	0	Floor	Ceiling	Wall	0	Floor	Ceiling	Wall	0	Floor	Ceiling	Wall	0	Floor	Ceiling	Wall	0	Floor	Ceiling	Wall	0
RCR 0	61	61	61	61	60	60	60	60	57	57	55	55	55	55	55	53	53	53	53	52	52	52	52	52	52	52	52	
1	56	54	52	50	55	53	49	51	48	49	46	47	45	44	47	45	44	44	44	47	45	44	44	44	44	44	44	
2	52	48	44	41	50	47	41	45	40	43	39	42	38	37	42	38	37	37	37	42	38	37	37	37	37	37	37	
3	47	42	38	35	46	41	35	40	37	39	34	37	33	32	37	33	32	32	32	37	33	32	32	32	32	32	32	
4	43	38	33	30	42	37	30	36	29	34	29	33	28	27	33	28	27	27	27	33	28	27	27	27	27	27	27	
5	40	33	29	25	39	33	25	32	25	31	25	30	24	23	30	24	23	23	23	30	24	23	23	23	23	23	23	
6	37	30	25	22	36	29	22	28	22	27	21	27	21	20	27	21	20	20	20	27	21	20	20	20	20	20	20	
7	34	27	22	19	33	26	19	26	19	25	19	24	19	18	24	19	18	18	18	24	19	18	18	18	18	18	18	
8	31	24	20	19	30	24	17	23	16	22	16	22	16	15	22	16	15	15	15	22	16	15	15	15	15	15	15	
9	29	22	17	14	28	21	14	21	14	20	14	20	14	13	20	14	13	13	13	20	14	13	13	13	13	13	13	
10	27	20	15	13	26	19	13	19	13	18	13	18	13	12	18	13	12	12	12	18	13	12	12	12	12	12	12	

Numbers indicate percentage values of reflectivity.

Go to www.focalpointlights.com for additional photometric data.

note: Photometric testing performed in an independent lab with standard lamps and ballasts. Lamp and ballast type and configuration will affect photometric performance.

Seem® 4

FLUORESCENT - RECESSED LOUVER

FSM4-PL-1T5HO-1C-120-S-G1-WH-4'

Filename: FSM4PL1T5H.IES
Test #: 15908.0

Lumens: 3266lm
Efficiency: 65%

CANDLEPOWER DISTRIBUTION

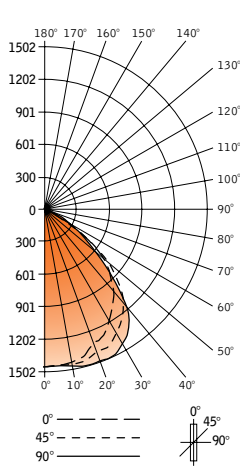

Vertical Angle	Horizontal Angle					Zonal Lumens
	0°	22.5°	45°	67.5°	90°	
0°	1462	1462	1462	1462	1462	1462
5°	1454	1454	1455	1457	1457	139
15°	1413	1427	1455	1489	1498	413
25°	1295	1325	1405	1478	1502	649
35°	1102	1164	1252	1323	1367	781
45°	853	923	969	911	885	711
55°	500	568	503	417	432	438
65°	45	57	121	162	172	111
75°	12	13	13	25	24	18
85°	3	3	6	6	6	5
90°	0	0	0	0	0	0
95°	0	0	0	0	0	0
105°	0	0	0	0	0	0
115°	0	0	0	0	0	0
125°	0	0	0	0	0	0
135°	0	0	0	0	0	0
145°	0	0	0	0	0	0
155°	0	0	0	0	0	0
165°	0	0	0	0	0	0
175°	0	0	0	0	0	0
180°	0	0	0	0	0	0

LUMEN SUMMARY

Zone	Lumens	% Lamp	% Fixture
0-30°	1201	24.0	36.8
0-40°	1982	39.6	60.7
0-60°	3131	62.6	95.9
0-90°	3266	65.3	100
Total Luminaire 0-180°	3266	65.3	100

LUMINANCE DATA (CD/M²)

Vertical Angle	0°	45°	90°
45°	11823	13431	12267
55°	8544	7595	7382
65°	1044	2806	3989
75°	454	492	909
85°	337	675	675

CO-EFFICIENTS OF UTILIZATION

Floor Ceiling Wall	80				70			20		50		30		10		00
	70	50	30	10	70	50	10	50	10	50	10	50	10	50	10	00
RCR 0	78	78	78	78	76	76	76	73	73	69	69	67	67	67	67	65
1	73	71	69	67	71	69	66	67	64	64	62	62	60	59	59	59
2	68	65	61	58	67	63	58	61	57	59	55	57	54	53	53	53
3	64	59	55	51	62	58	51	56	50	54	49	53	48	47	47	47
4	59	53	48	45	58	5	45	51	44	49	44	48	43	42	42	42
5	55	48	43	39	54	47	39	46	39	45	38	44	38	37	37	37
6	51	43	38	35	50	43	35	42	34	41	34	40	34	33	33	33
7	47	39	34	31	43	39	31	38	30	37	30	36	30	29	29	29
8	43	35	30	27	42	35	27	34	27	33	26	32	26	25	25	25
9	40	32	27	23	39	31	23	31	23	30	23	29	23	22	22	22
10	37	29	24	21	36	28	21	28	20	27	20	27	20	19	19	19

Numbers indicate percentage values of reflectivity.

Go to www.focalpointlights.com for additional photometric data.

Seem® 4

FLUORESCENT - RECESSED LOUVER

FSM4-PL-1T8-1C-120-S-G1-WH-4'

Filename: FSM4PL1T8.IES
Test #: 15902.0

Lumens: 2124lm
Efficiency: 72%

CANDLEPOWER DISTRIBUTION

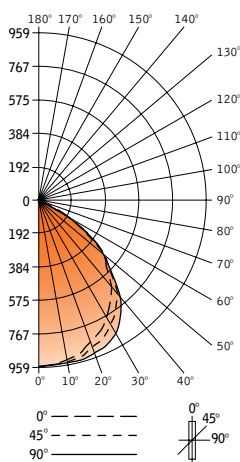

Vertical Angle	Horizontal Angle					Zonal Lumens
	0°	22.5°	45°	67.5°	90°	
0°	959	959	959	959	959	959
5°	952	952	952	955	957	91
15°	916	923	938	951	956	266
25°	839	852	879	910	926	408
35°	724	741	774	804	823	486
45°	556	574	586	583	597	449
55°	368	379	359	334	337	320
65°	54	69	101	114	119	92
75°	10	10	10	16	12	12
85°	1	1	1	1	3	1
90°	0	0	0	0	0	0
95°	0	0	0	0	0	0
105°	0	0	0	0	0	0
115°	0	0	0	0	0	0
125°	0	0	0	0	0	0
135°	0	0	0	0	0	0
145°	0	0	0	0	0	0
155°	0	0	0	0	0	0
165°	0	0	0	0	0	0
175°	0	0	0	0	0	0
180°	0	0	0	0	0	0

LUMEN SUMMARY

Zone	Lumens	% Lamp	% Fixture
0-30°	764	25.9	36.0
0-40°	1250	42.4	58.8
0-60°	2019	68.4	95.0
0-90°	2124	72.0	100
Total Luminaire 0-180°	2124	72.0	100

LUMINANCE DATA (CD/M²)

Vertical Angle	0°	45°	90°
45°	7466	7868	8016
55°	6092	5943	5578
65°	1213	2269	2673
75°	367	367	440
85°	109	109	327

CO-EFFICIENTS OF UTILIZATION

Floor Ceiling Wall	80				70			20		50		30		10		00
	70	50	30	10	70	50	10	50	10	50	10	50	10	50	10	00
RCR 0	86	86	86	86	84	84	84	80	80	77	77	73	73	73	73	72
1	81	78	76	74	79	77	73	74	70	71	68	68	66	65	65	65
2	74	71	67	64	74	70	63	67	62	65	51	53	59	58	58	58
3	70	64	60	56	69	63	56	61	55	59	54	58	53	52	52	52
4	65	58	53	49	64	57	49	55	48	54	48	53	47	46	46	46
5	60	52	47	43	59	52	43	50	42	49	42	48	41	40	40	40
6	56	47	42	38	54	47	38	45	37	44	37	43	37	35	35	35
7	51	43	37	33	50	42	33	41	33	40	33	39	32	31	31	31
8	47	38	33	29	46	38	29	37	29	36	28	35	28	27	27	27
9	43	34	29	25	42	34	25	33	25	32	25	32	25	23	23	23
10	40	32	26	22	39	31	22	30	22	29	22	29	22	21	21	21

Numbers indicate percentage values of reflectivity.

Go to www.focalpointlights.com for additional photometric data.

EXAMPLE 16' RUN

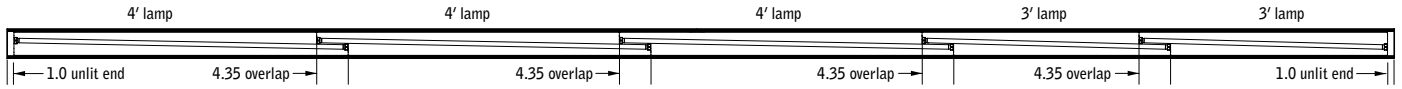

1-T5/T5HO

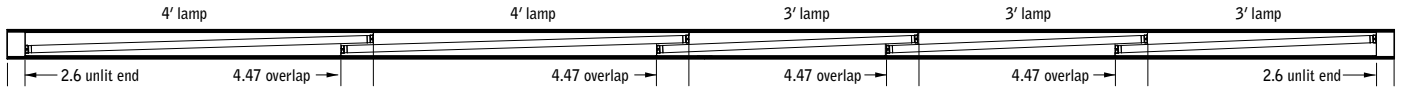

1-T8

Nominal run length (ft)	1-T5/T5HO (4.35" overlap)			1-T8 (4.47" overlap)		
	Lamp quantity		Unlit ends (in)	Lamp quantity		Unlit ends (in)
	3'	4'		3'	4'	
8	3		0.5		2	1.8
12	2	2	0.3*	3	1	0.3
16	2	3	1.0	3	2	2.6
20	5	2	0.8	6	1	1.0
24	1	6	0.9	2	5	1.1
28	11		1.0	9	1	1.8
32	7	4	1.4	5	5	1.8
36	10	3	1.4	1	9	1.9
40	13	2	1.4	4	8	0.4
44	9	6	1.9		12	0.4
48	19		1.5	7	8	1.1

* special lamp stagger to decrease end darkness.

Notes:

- Lamp overlap is consistent throughout run.
- Unlit ends vary to provide even light throughout run.
- Standard configurations listed, consult factory for additional options.