

# Seem® 2 LED Perimeter

FSM2L\_FL2



FOCAL POINT®

**⚠ MUST BE INSTALLED PRIOR TO DRYWALL /HARD CEILING ⚠**  
**READ ALL INSTALLATION INSTRUCTIONS BEFORE BEGINNING INSTALLATION**

## FOCAL POINT PARTS

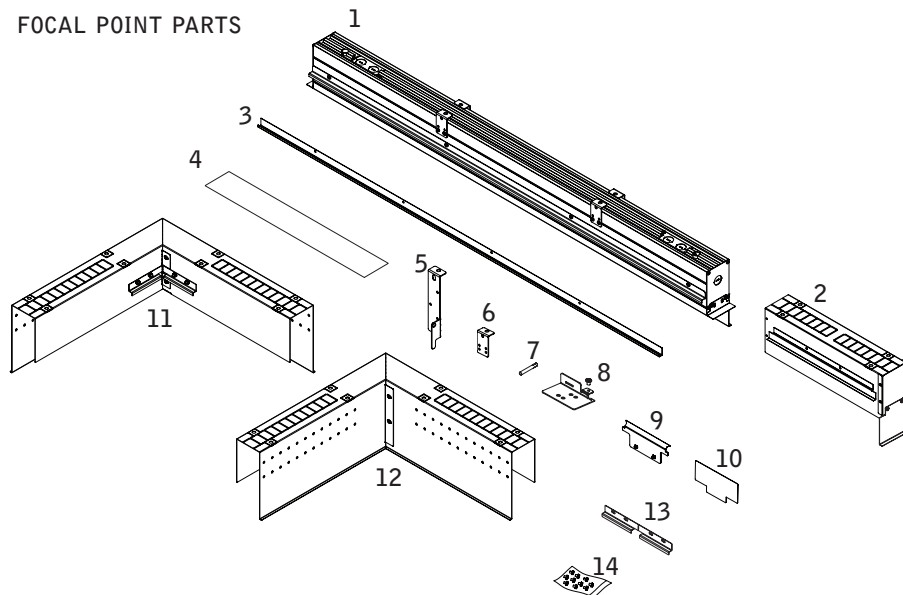

KEY ATTENTION



POWER OFF



POWER ON

## PARTS LIST

1 HOUSING

2 SLIDING SLEEVE (ss)  
 (SHIPPED INSTALLED. SSB INDICATES  
 A SLIDING SLEEVE AT BOTH ENDS)

3 J-RAIL

4 FINISH PLATE

5 TIE-WIRE/GRID BRACKET

6 TIE-WIRE BRACKET

7 JOINER PIN

8 JOINER BRACKET  
 ASSEMBLY

9 LENS END PIECE

10 LENS TOOL

11 OUTSIDE CORNER

12 INSIDE CORNER

13 CORNER J-RAIL

14 HARDWARE BAG

## BY OTHERS



GRID CEILING -  
 15/16" OR 9/16"  
 FLAT TEE MAIN  
 RUNNER REQUIRED  
 FOR FINISH EDGE.

## HOUSING TYPES (4' SHOWN)



INDIVIDUAL (MAY INCLUDE SLIDING SLEEVES)

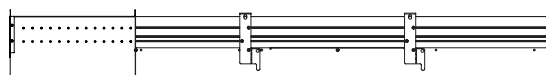

START (SHOWN WITH SLIDING SLEEVE)



INTERMEDIATE

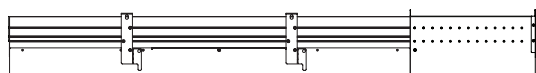

END (SHOWN WITH SLIDING SLEEVE)

## WALL/CEILING PREP

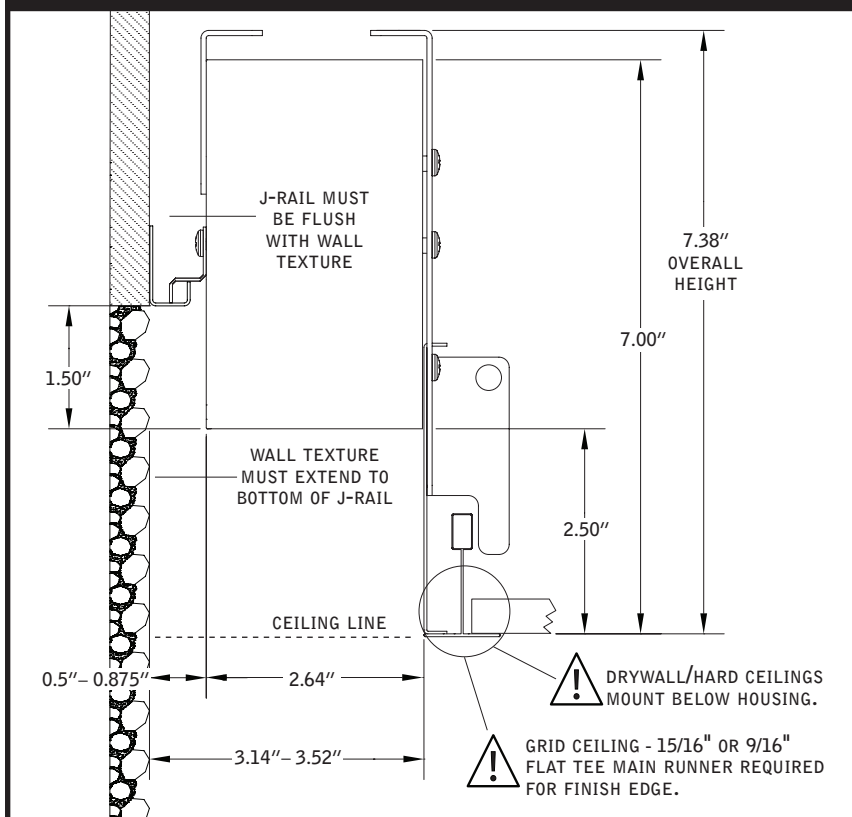

Luminaires must be installed by a qualified electrician (check with local and national codes for proper installation).  
 To prevent electrical shock, disconnect electrical supply before installation or servicing.

## BASIC INSTALLATION STEPS 1-13

SLIDING SLEEVES SEE PG 3  
CORNERS SEE PG 4



FOCAL POINT RECOMMENDS  
STARTING WITH CORNER  
INSTALLATION IF APPLICABLE

SLIDING SLEEVE PAIRS (SSB) START  
& END WITH A SLIDING SLEEVE

1

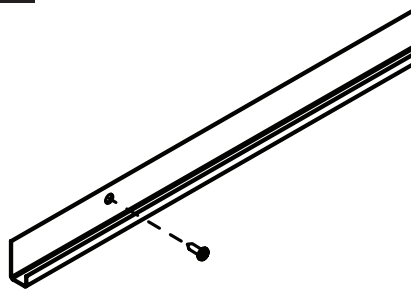

MOUNT J-RAIL TO WALL  
HARDWARE BY OTHERS

2

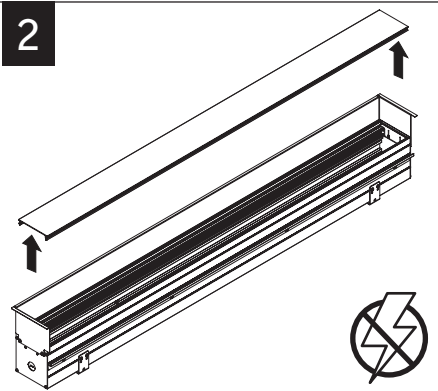

⚠️ AVOID ALL CONTACT WITH LED SURFACE,  
LEDs ARE EASILY DAMAGED!

3

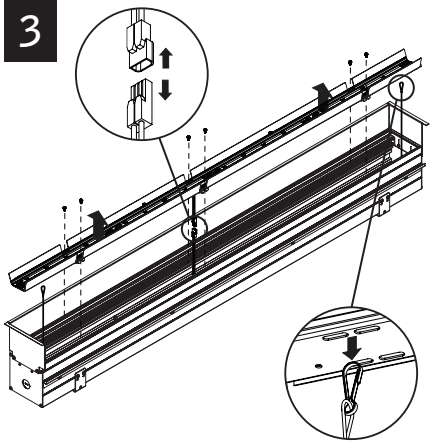

### GRID

4

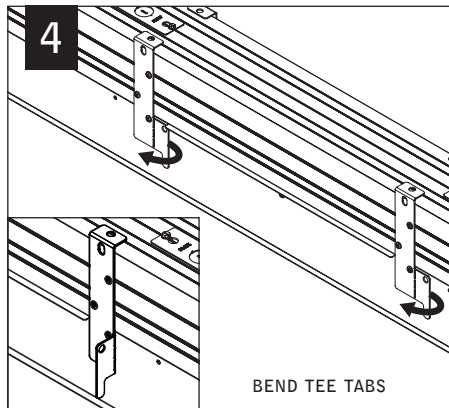

BEND TEE TABS

### DRYWALL/HARD CEILING

5

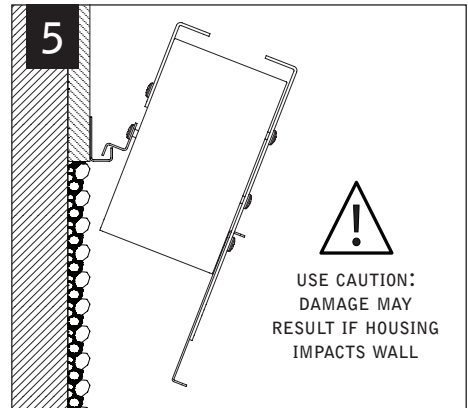

⚠️ USE CAUTION:  
DAMAGE MAY  
RESULT IF HOUSING  
IMPACTS WALL

### GRID

5

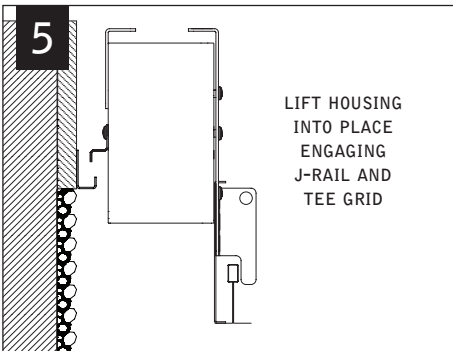

LIFT HOUSING  
INTO PLACE  
ENGAGING  
J-RAIL AND  
TEE GRID

6

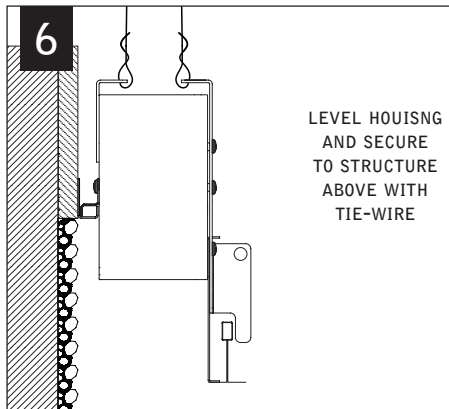

LEVEL HOUSING  
AND SECURE  
TO STRUCTURE  
ABOVE WITH  
TIE-WIRE

7

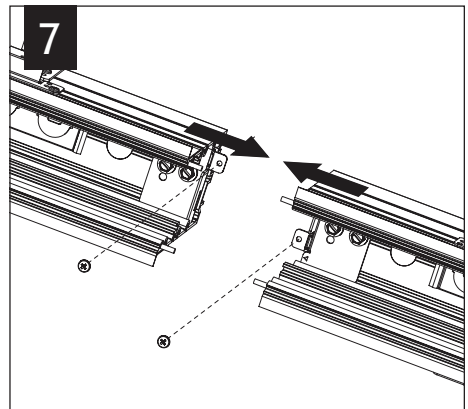

8

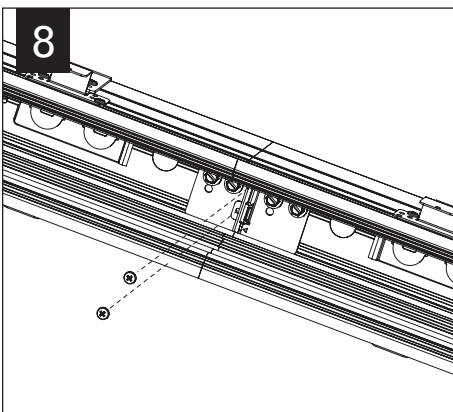

9

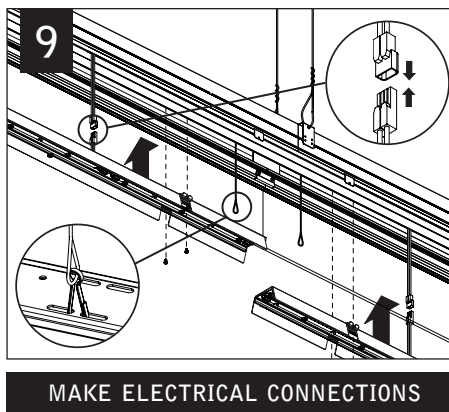

MAKE ELECTRICAL CONNECTIONS

10

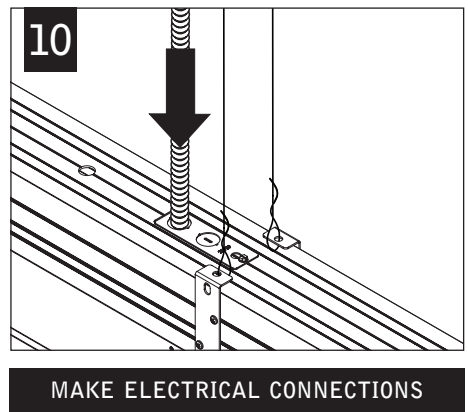

MAKE ELECTRICAL CONNECTIONS

REPEAT STEPS 2 - 9 FOR EACH HOUSING SECTION

Luminaires must be installed by a qualified electrician (check with local and national codes for proper installation).  
To prevent electrical shock, disconnect electrical supply before installation or servicing.

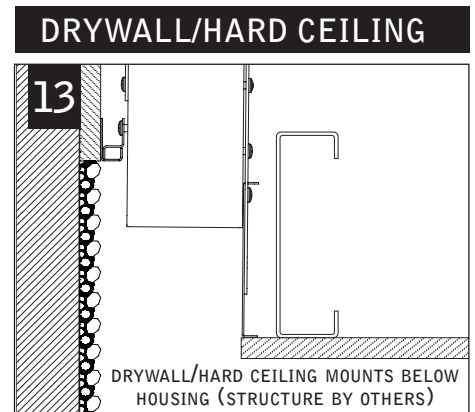
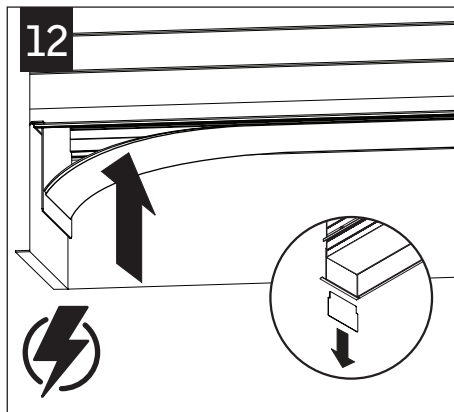
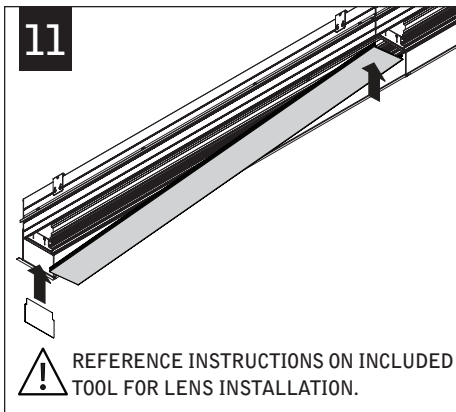

**EMERGENCY**

**I**

SEE BATTERY MANUFACTURER INSTRUCTIONS

EMERGENCY MAXIMUM MOUNTING HEIGHT:  
19.00'

**SLIDING SLEEVES**

**!** MAX LENGTH 12" PER SLEEVE

**!** SLIDING SLEEVES & CORNERS DO NOT INTEGRATE

**SINGLE SLIDING SLEEVE (SS):**  
EXAMPLE:  
 $21' \text{ RUN LENGTH} - 20' \text{ HOUSING} = 12" \text{ SLIDING SLEEVE}$

**SLIDING SLEEVE PAIR (SSB):**  
EXAMPLE:  
 $(21' \text{ RUN LENGTH} - 20' \text{ HOUSING}) / 2 = 6" \text{ SLIDING SLEEVE ON EACH END}$

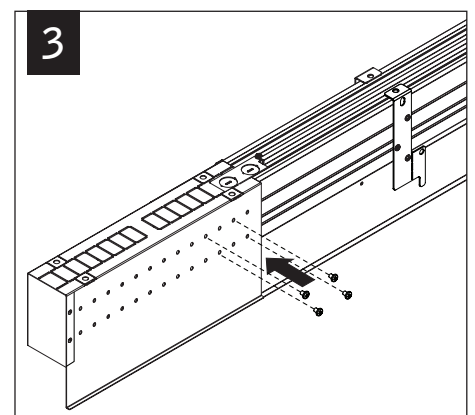
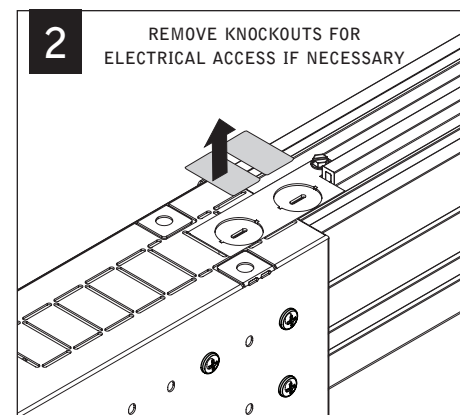
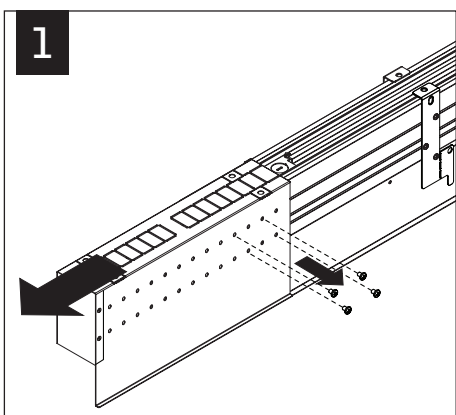

Luminaires must be installed by a qualified electrician (check with local and national codes for proper installation).  
To prevent electrical shock, disconnect electrical supply before installation or servicing.

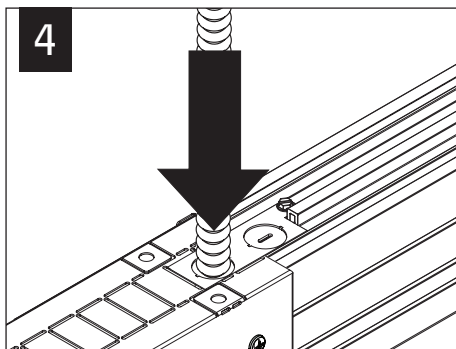

MAKE ELECTRICAL CONNECTIONS

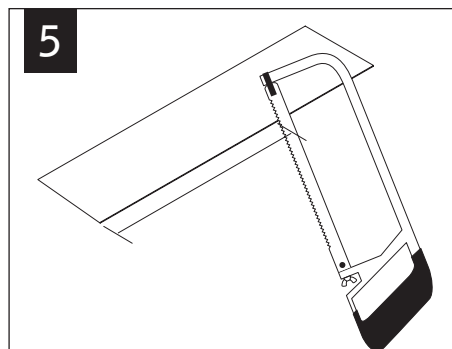

CUT FINISH PLATE TO  
DETERMINED LENGTH

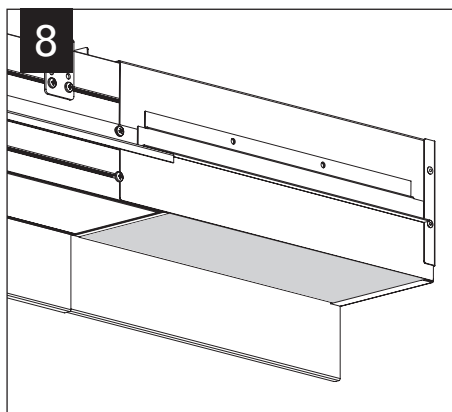
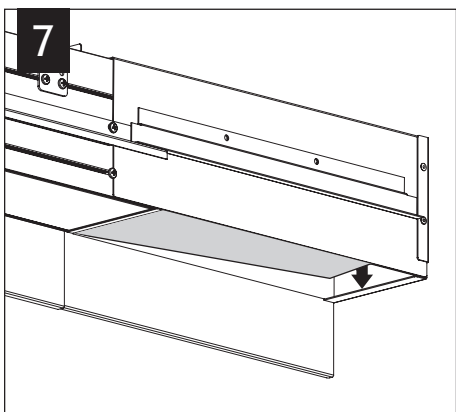
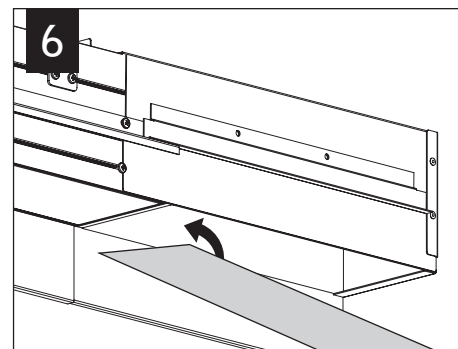

## CORNERS



3" MIN / 15" MAX PER SIDE

INSIDE CORNER:

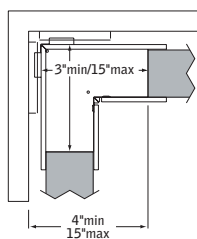

OUTSIDE CORNER:

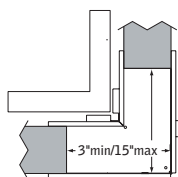

CORNERS &  
SLIDING SLEEVES  
DO NOT INTEGRATE

1

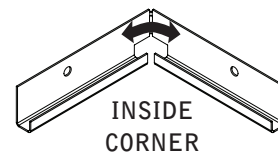

INSIDE  
CORNER

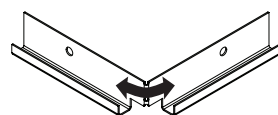

OUTSIDE CORNER

2

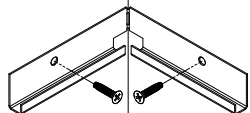

INSIDE CORNER SHOWN  
HARDWARE BY OTHERS

3

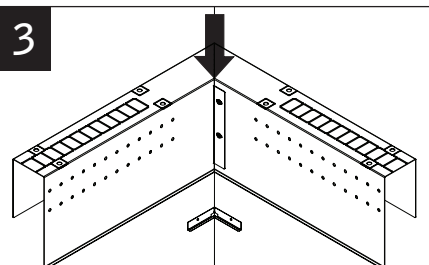

LIFT HOUSING INTO  
PLACE ENGAGING J-RAIL

4

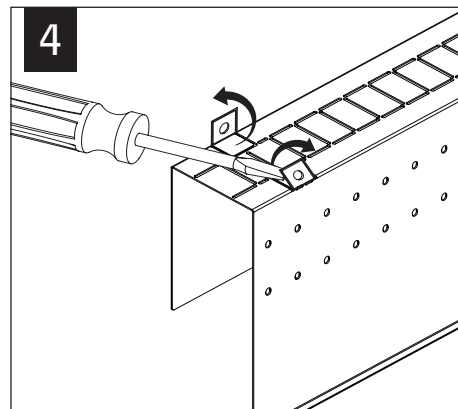

Luminaires must be installed by a qualified electrician (check with local and national codes for proper installation).  
To prevent electrical shock, disconnect electrical supply before installation or servicing.

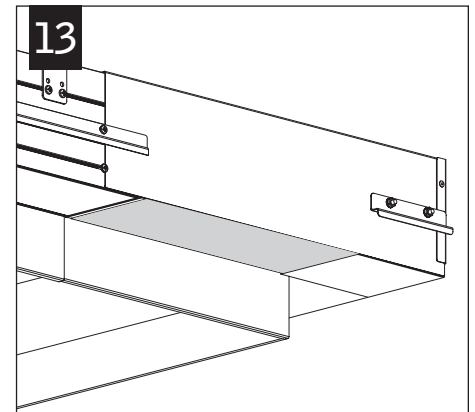
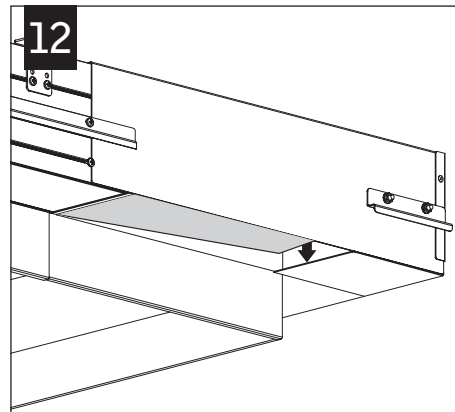
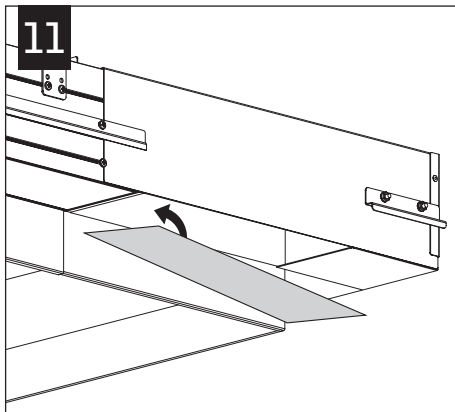
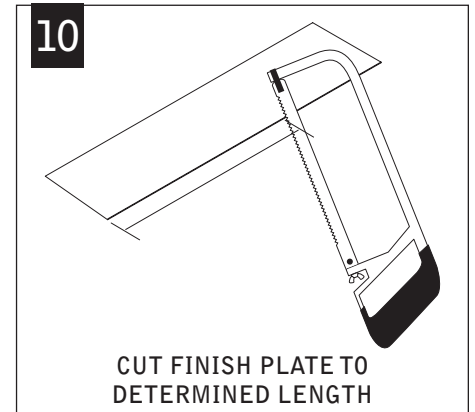
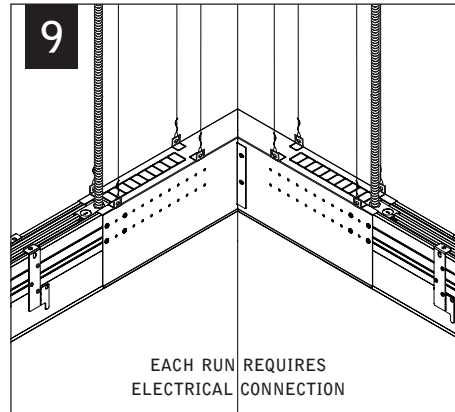
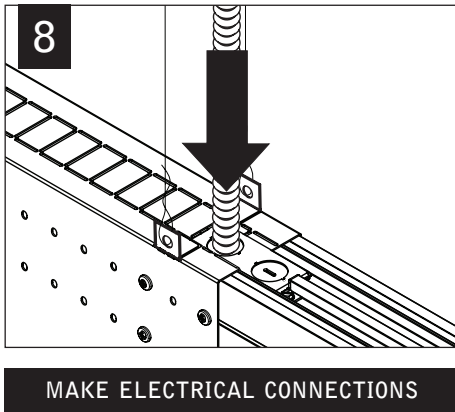
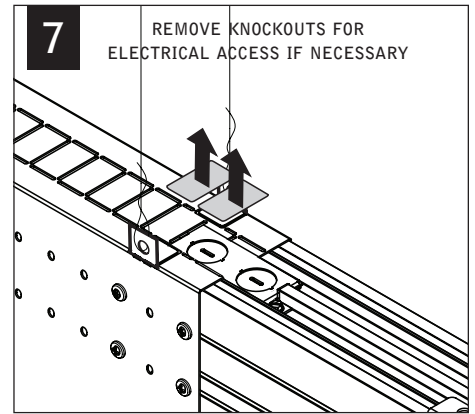
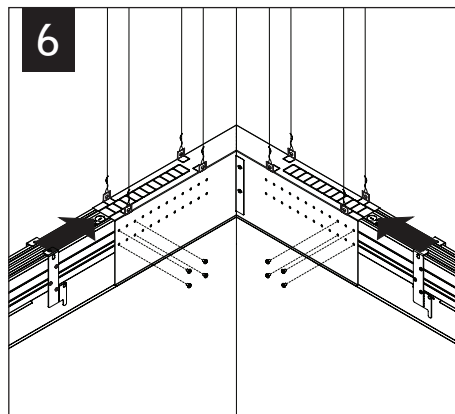
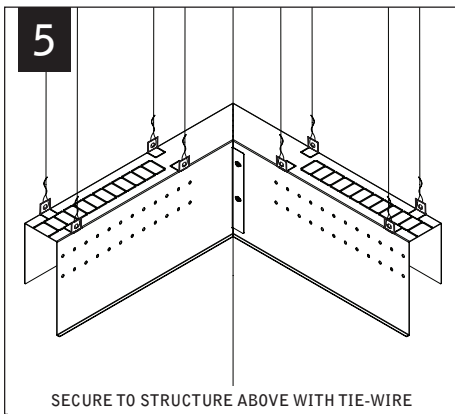

## DRIVER SERVICE

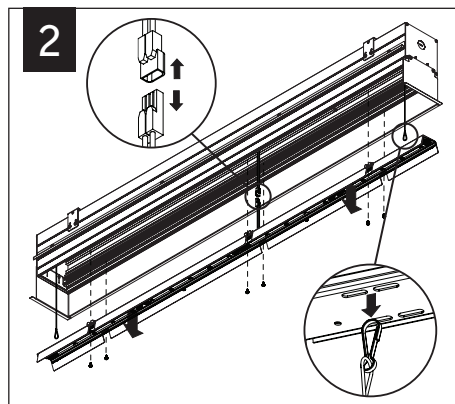
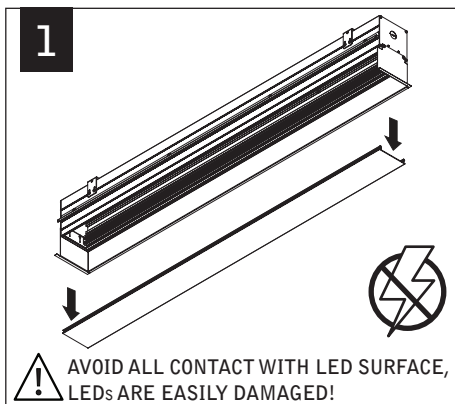

Contractor is responsible for adequately reinforcing walls and/or ceilings to support luminaire weight. Focal Point, LLC accepts no responsibility for inadequately reinforced walls and/or ceilings. The information contained in this drawing is the sole property of Focal Point, LLC. Any reproduction in part or whole without the written permission of Focal Point, LLC is prohibited.