

# Seem<sup>®</sup> 4 Drywall/Hard/Specialty Ceiling

LED

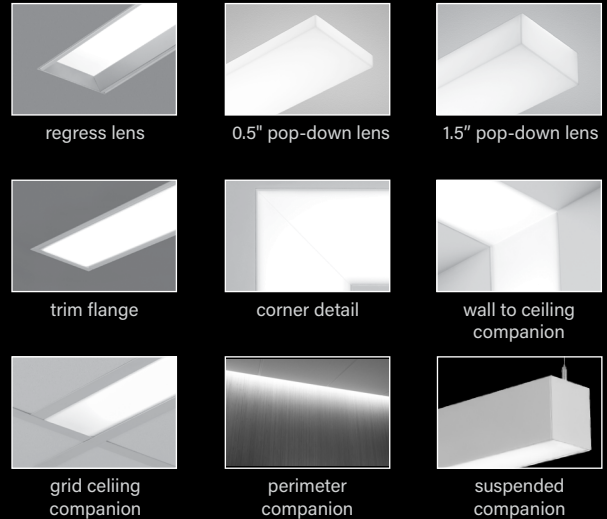

## DIMENSIONAL DATA

### Asymmetric, Batwing, Flush Lens Trimless mud-in

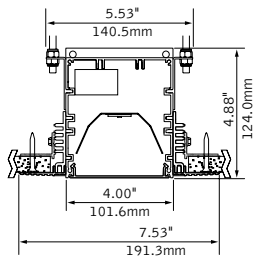

note: 0.375"min - 2.125"max ceiling thickness

### Hard surface

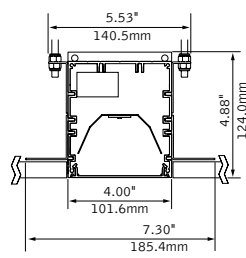

note: 0.375"min - 2.125"max ceiling thickness

### Trim flange

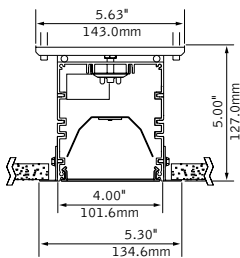

### No Flange

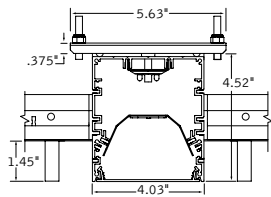

### Specialty ceiling examples



## Additional Shielding Options

### Regress lens

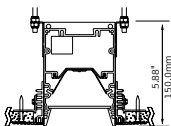

### 1.5" Pop-Down lens

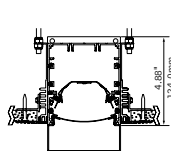

### 0.5" Pop-Down lens

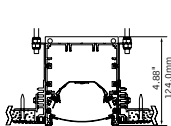

## FEATURES

Extruded aluminum 4" aperture recessed slot LED integrates with drywall or hard ceilings or walls in a variety of mounting styles for a clean, unobtrusive aesthetic.

Individual units and continuous runs in 1" increments.

Available in flush, asymmetric, asymmetric room fill, batwing, regress, 0.5" or 1.5" pop-down lens.

Tunable White: Supports human activity, well-being, and preferences with a light quality that evolves throughout the day.

Connected Solutions: Integrates with wired and wireless building lighting control systems.

PoE compatible: Integrates with Power over Ethernet lighting systems via standard, low-voltage wires.

## DISTRIBUTIONS

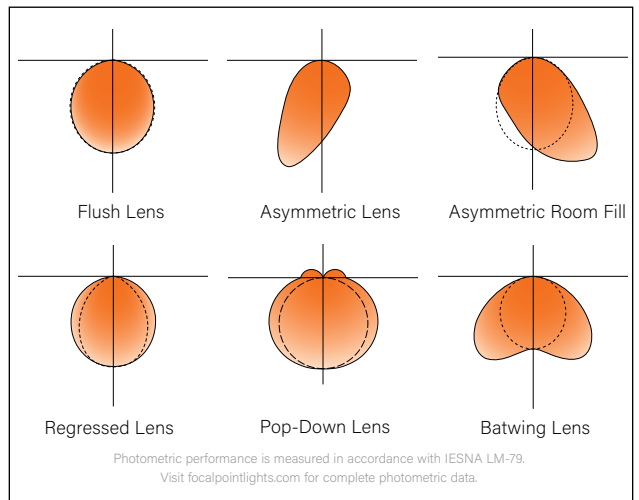

Photometric performance is measured in accordance with IESNA LM-79. Visit focalpointlights.com for complete photometric data.

fixture:

project:

**DETAILS**

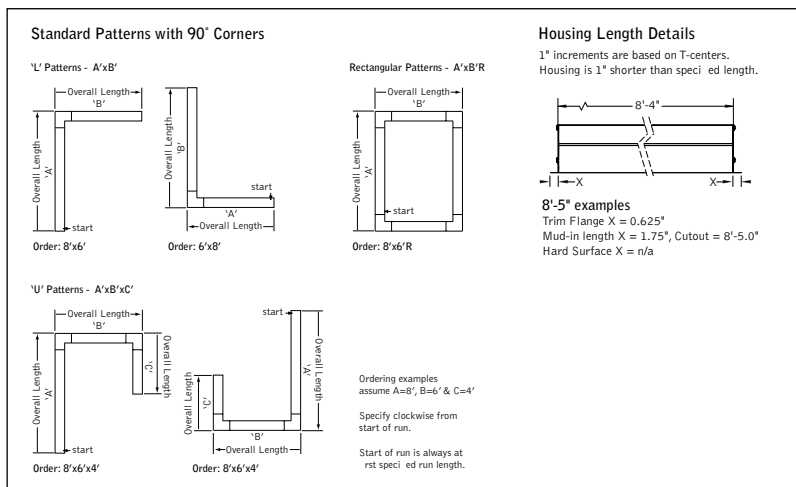

**4' PERFORMANCE CHART**

Lumen Output	Nominal Lumens	BW		FL		AS		AF	
		Tested System Watts	LPW	Tested System Watts	LPW	Tested System Watts	LPW	Tested System Watts	LPW
275LF	1100	8.8	125	9.1	121	8.5	130	8.6	128
375LF	1500	11.3	133	11.7	129	10.8	138	11	137
625LF	2500	19	131	19.9	126	18.3	137	18.5	135
875LF	3500	27	130	27.9	125	25.9	135	26.2	133
1000LF	4000	31.1	129	32.2	124	29.8	134	30.2	132
1125LF	4500	35.4	127	36.6	123	33.9	133	34.4	131
1250LF	5000	39.8	126	41.2	121	38.1	131	38.6	129

Based on 3500K, 80 CRI, 4' lengths. Lumen multiplier: 90+ CRI = 0.87. Lumen output may vary +/- 5%. Actual wattage may vary +/- 5%.

**4' PERFORMANCE CHART - REGRESS**

Lumen Output	Nominal Lumens	SR		SRXP	
		Tested System Watts	LPW	Tested System Watts	LPW
275LF	1100	9.4	117	8.7	127
375LF	1500	12.5	120	11.1	135
625LF	2500	21.1	118	18.7	134
875LF	3500	30	117	26.5	132
1000LF	4000	34.6	116	30.6	131
1125LF	4500	39.5	114	34.8	129
1250LF	5000	44.4	113	39	128

Based on 3500K, 80 CRI, 4' lengths. Lumen multiplier: 90+ CRI = 0.87. Lumen output may vary +/- 5%. Actual wattage may vary +/- 5%.

**4' PERFORMANCE CHART - POP-DOWN**

Lumen Output	Nominal Lumens	0.5"		1.5"	
		Tested System Watts	LPW	Tested System Watts	LPW
275LF	1100	11	100	11.9	93
375LF	1500	14.7	102	15.8	95
625LF	2500	25	100	27	93
750LF	3000	30.3	99	32.7	92
875LF	3500	35.7	98	38.6	91
1000LF	4000	41.3	97	44.7	89

Based on 3500K, 80 CRI, 4' lengths. Lumen multiplier: 90+ CRI = 0.87. Lumen output may vary +/- 5%. Actual wattage may vary +/- 5%.

**STANDARD WHITE**

**Luminaire Series**

**FSM4L**

Seem 4 LED FSM4L

**Shielding**

Asymmetric Lens AS

Asymmetric Room Fill AF

Batwing Lens BW

Flush Satin Lens FL

0.5" Pop-Down Lens (1000LF max.) PD05

1.5" Pop-Down Lens (1000LF max. individual units only) PD15

Regress Lens\* SR

Regress High Performance Lens\* SRXP

\* (Ceiling applications only)

**Lumen Output**

275 Lumens per foot (Not available with LH1) 275LF

375 Lumens per foot (Not available with LH1) 375LF

625 Lumens per foot (BW, FL & SR 3' min. individual units only with LH1. SRXP 4' min. individual units only with LH1.) 625LF

750 Lumens per foot (Pop-Down Lenses only) 750LF

875 Lumens per foot (SR & SRXP 3' min. individual units only with LH1.) 875LF

1000 Lumens per foot (SR & SRXP 3' min. individual units only with LH1.) 1000LF

1125 Lumens per foot 1125LF

1250 Lumens per foot 1250LF

**Color Temperature**

2700K, 80+ CRI or 90+ CRI 27K or 927K

3000K, 80+ CRI or 90+ CRI 30K or 930K

3500K, 80+ CRI or 90+ CRI 35K or 935K

4000K, 80+ CRI or 90+ CRI 40K or 940K

**Circuits & Zones**

1 Circuit, non-emergency 1C

Consult Ordering Guide on page 6 for multiple circuiting and zoning options

Consult Ordering Guide on page 6 for multiple circuiting and zoning options

**Voltage**

120/277 UNV Volt UNV

Low Voltage LV

**Control System & Dimming Level**

0-10V - 10% Dimming LD1

0-10V - 1% Dimming L11

Low Voltage, PoE compatible LVN

(No driver. Not available with EM or EC. LV Voltage only)

Lutron Hi-Lume EcoSystem (LDE1) - 1% Dimming (625LF min.) LH1

DALI 1% Dimming (1000LF max.) D11

Wattstopper Fixture Sensor\*\* LMFS1

Low Density - 1% Dimming

Wattstopper Fixture Sensor\*\* LMFSD

High Density - 1% Dimming

Lutron Athena Wireless Sensor\*\* LAWS

Enlighted Smart Sensor - 1% Dimming\*\* ENL1

WaveLinx Pro - 1% Dimming\*\* WLXP

\*\* (XF1, XF2 and XFF only. 7 min. with ECD/EM.)

Not available with Pop-Down Lenses. See sensor layout guide

**Ceiling Configuration**

No Flange for specialty ceilings NF

(Ex. slat, panel, cloud systems. 3' minimum with Lutron.)

Trim Flange Drywall (3' minimum with Lutron) TF

Trim Flange Wood (3' minimum with Lutron) TFW

Mud-in Trimless, pre-set for 1/2" Drywall XF1

Mud-in Trimless, pre-set for 5/8" Drywall XF2

Mud-in Trimless, set thickness in field XFF

(Mounting equipment assembled in field)

Non-Drywall Hard Surface XFN

Hard Surface, Wood XFW

**Factory Options**

(See page 6 for ordering details for DC, EC, EM & ECD.)

Chicago Plenum (Not available with Flex Whip) CP

Daylight Circuit \_DC

Emergency Circuit \_EC

Emergency Battery Pack† \_EM

Emergency Control Device† \_ECD

† (4' minimum. 6' minimum with patterns. 120/277 Volt only. Not available at corners.)

6' New York City Flex Whip 120V or 277V FNY1 or FNY2

6' Flex Whip FW

**Finish**

Matte White Housing WH

**Luminaire Length**

Specify luminaire/row length in 1" increments \_ft\_in

(2" minimum. Housing length is 1" shorter than specified. Leave blank for patterns.)

**Pattern Options**

(4' min. length. Not available with Pop-Down Lenses. Consult factory for other pattern options.)

'L' pattern A' x B'

'U' pattern A' x B' x C'

Rectangular pattern A' x B' R



Options in orange qualify for the Quickship program. 1000' total, 48' maximum per pattern section. Refer to Quickship Guide for complete details including EM/EC options.

fixture:

project:

**DETAILS**

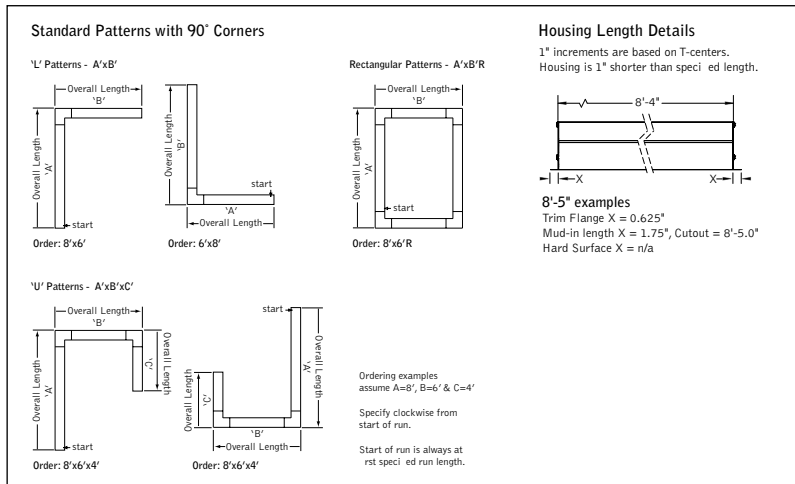

**TUNABLE WHITE**

**Luminaire Series**

Seem 4 LED FSM4L

**Shielding**

Batwing Lens BW

Flush Satin Lens FL

0.5" Pop-Down Lens (750LF max.) PD05

1.5" Pop-Down Lens (750LF max. individual units only) PD15

Regress Lens\* SR

Regress High Performance Lens\* SRXP

\*(1000LF max. Ceiling applications only)

**Lumen Output**

275 Lumens per foot (BW, FL, SR & SRXP 3' min. with D1TW) 275LF

375 Lumens per foot (BW, FL, SR & SRXP 3' min.) 375LF

625 Lumens per foot (Pop-Down Lenses only) 625LF

750 Lumens per foot (Pop-Down Lenses only) 750LF

875 Lumens per foot 875LF

1000 Lumens per foot 1000LF

1125 Lumens per foot 1125LF

**Color Temperature**

Tunable White: 2700-6500K, 80+ CRI 2765T

Tunable White: 2700-6500K, 90+ CRI 92765T

**Circuits & Zones**

1 Circuit, non-emergency 1C

Consult Ordering Guide on page 6 for multiple circuiting and zoning options \_C\_Z\_DL

**Voltage**

120/277 UNV Volt UNV

**Control System & Dimming Level**

DALI 1% Dimming D1TW

(Default driver offers DT6 control. It requires two addresses, one for intensity & one for CCT tuning. Consult factory for DT8. Extended lead time applies.)

Lutron Athena Wireless Sensor\*\* LAWS

Enlighted Smart Sensor - 1% Dimming\*\* ENL1

\*\*Consult factory. Not available with Pop-Down lenses. See sensor layout guide

**Ceiling Configuration**

No Flange for specialty ceilings NF

(Ex. slat, panel, cloud systems. 3' minimum with Lutron.) TF

Trim Flange Drywall (3' minimum with Lutron) TFW

Trim Flange Wood (3' minimum with Lutron) XFF

Mud-in Trimless, pre-set for 1/2" Drywall XF1

Mud-in Trimless, pre-set for 5/8" Drywall XF2

Mud-in Trimless, set thickness in field (Mounting equipment assembled in field) XFF

Non-Drywall Hard Surface XFN

Hard Surface, Wood XFW

**Factory Options**

(See page 6 for ordering details for DC, EC, EM & ECD.)

Chicago Plenum CP

Daylight Circuit \_DC

Emergency Circuit \_EC

Emergency Battery Pack† \_EM

Emergency Control Device† \_ECD

†(Consult factory.)

6' New York City Flex Whip 120V or 277V FNY1 or FNY2

6' Flex Whip FW

**Finish**

Matte White Housing WH

**Luminaire Length**

Specify luminaire/row length in 1" increments \_ft\_in

(2' minimum. Housing length is 1" shorter than specified. Leave blank for patterns.)

**Pattern Options**

(4' min. length. Not available with Pop-Down Lenses. Consult factory for other pattern options.)

'L' pattern A' x B'

'U' pattern A' x B' x C'

Rectangular pattern A' x B' R

**TW 4' PERFORMANCE CHART**

Lumen Output	Nominal Lumens	Tested System Watts	LPW	
			BW	FL
275LF	1100	13.30	87.3	83.2
375LF	1500	17.34	90.8	86.5
625LF	2500	27.84	94.0	89.5
875LF	3500	37.22	98.9	94.2
1000LF	4000	42.39	99.2	94.4
1125LF	4500	50.27	93.9	89.4

Based on 2700K, 80CRI, 4' lengths. Lumen output may vary +/- 5%. Actual wattage may vary +/- 5%.

**TW 4' PERFORMANCE CHART - REGRESS**

Lumen Output	Delivered Lumens	Tested System Watts	LPW	
			SR	SRXP
275LF	1100	14.72	74.4	88.6
375LF	1500	19.36	77.5	92.3
625LF	2500	31.47	79.6	94.8
875LF	3500	42.01	83.4	99.4
1000LF	4000	50.68	79.2	94.3

Based on 2700K, 80CRI, 4' lengths. Lumen output may vary +/- 5%. Actual wattage may vary +/- 5%.

**TW 4' PERFORMANCE CHART - POP-DOWN**

Lumen Output	Nominal Lumens	0.5"		1.5"	
		Tested System Watts	LPW	Tested System Watts	LPW
275LF	1100	17.14	64.7	16.33	67.3
375LF	1500	22.79	66.5	21.58	70.0
625LF	2500	35.49	70.6	33.96	73.8
750LF	3000	42.39	70.8	40.28	74.5

Based on 2700K, 80CRI, 4' lengths. Lumen output may vary +/- 5%. Actual wattage may vary +/- 5%.

**Lumen Multipliers**

CRI	Multiplier
80+	1.00
90+	0.89

**Wattage Multipliers**

CCT	Multiplier
2700K	1.00
3000K	0.92
3500K	0.88
4000K	0.86
5000K	0.85
5700K	0.87
6500K	0.90



Focal Point provides flexibility in meeting the needs of each project by integrating with several building lighting control systems. A variety of sensors, drivers and other components can be specified that allow the luminaires to communicate with wired and wireless networks. All zoning can be digitally reconfigured through the application software. Daylight harvesting, occupancy sensing, integration with HVAC systems, and individual controls enable the monitoring and modulating of light levels and temperature in order to save energy, reduce costs and maximize occupants' comfort. All Connected Solutions luminaires require a compatible building control system.†

Connected Solution	Ordering Code	Model #**	Protocol	Compatible Networks*	Occupancy & Daylight	Temperature Reporting	Communication to Luminaire	Drivers
 <b>legrand</b> ® WATTSTOPPER®	LMFS1	LMFS-601 & LMFI-111	DLM Wireless	DLM	Enabled	No	Wireless	<b>Advance by Signify</b>
	LMFSD	LMFS-601						<b>Optotronic by eldoLED (Dexal)</b>
 <b>COOPER</b> Lighting Solutions	WLXP	OEM-WAA	WaveLinx Wireless	WaveLinx Pro Trellix	Enabled	No	Wireless (WaveLinx Pro Wireless Area Controller)	<b>Advance by Signify</b>
 <b>CRESTRON</b>	D11	Specified Driver	DALI	Crestron Zūm Wireless & SpaceBuilder	Enabled	No	Wired	<b>eldoLED ECOdrive</b>
	L11		0-10V					<b>Advance by Signify</b>
 <b>Enlighted</b>	ENL1	SU-5E-IOT	Enlighted RF	Enlighted	Integrated	Yes	Wireless	<b>Advance by Signify</b>
 <b>LUTRON</b>	LAWS	A-WN-D01-OCC-WH	DALI, 0-10V	Athena Wireless	Integrated	No	Wireless	<b>Advance by Signify</b>
	LH1	LDE1	EcoSystem	Quantum, Energi Savr Node, Energi TriPak	Enabled	No	Wired	<b>Lutron Hi-Lume</b>

\*Not all compatible networks may be listed. \*\*For performance data and additional control system details please visit the connected solutions manufacturer websites. Primary drivers are listed in **bold**. To specify a particular driver please consult factory. †Controls systems supplied by others.

# Ordering Guide



Direct Only Linear Circuitry, Zones & Factory Options

## HOW TO USE THIS GUIDE

Fill out the worksheet on the following page to specify your requirements for circuitry, zones, and factory options.

Refer to the run chart for standard run configurations, consult factory for custom configurations.

Complete the Totals / Ordering Codes at the bottom of the worksheet and add to your ordering logic on the cut sheet.

Submit the worksheet along with your order.

TOTAL RUN LENGTH: <u>32ft</u>		JOB NAME: _____			FIXTURE TYPE: _____			
HOUSING SECTION	SECTION LENGTH	SHARED ELECTRICAL FEED, NORMAL POWER			FACTORY OPTIONS			
		SWITCHING CIRCUIT	DIMMING ZONE	DAYLIGHT ZONE	DAYLIGHT CIRCUIT	EMERGENCY CIRCUIT	ECD	EM
1	8	1C	1Z					1EM
2	8	2C	2Z					
3	8	2C	2Z					
4	8				1DC			
<b>Totals / Ordering Codes</b>		<b>2C</b>	<b>2Z</b>		<b>1DC</b>			<b>1EM</b>

ORDERING: FSM4L-FL-625LF-35K- **2C2Z** -UNV-LD1-G2- **1DC-1EM** -WH-32ft

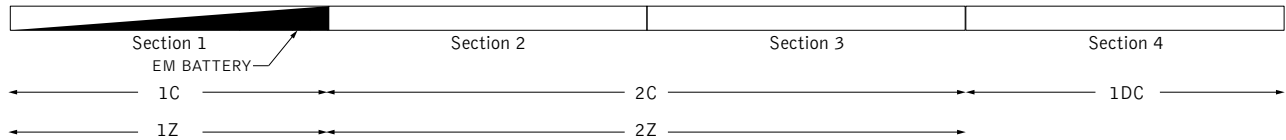

KEY	
<b>C = Switching Circuit</b> Switched Hot / Shared Neutral	<b>DC = Daylight Circuit</b> Switched Hot / Separate Neutral
<b>Z = Dimming Zone</b> Dimming Control Wires	<b>EC = Emergency Circuit</b> Switched Hot / Separate Neutral
<b>DL = Daylight Zone</b> Daylight Dimming Control Wires	<b>EM = Emergency Battery</b> Unswitched Hot / Shared Neutral
	<b>ECD = Emergency Control Device</b> Unswitched Hot / Separate Neutral

## DEFAULTS

- Zones and Factory Options illuminate entire sections from 4' to 8' in length.
- One shared or isolated circuit and zone required per housing section.
- Limit of one EM or ECD per housing section.
- Additional electrical feed required for applications greater than three shared circuits and zones.
- Each DC, EC and ECD require an additional electrical feed.
- ECD not available in the same housing section as EC.
- Longer lead times and additional pricing may apply for custom run configurations.

## CUSTOM LENGTHS

- If partial illumination of emergency or daylight section is required, indicate in ordering guide and add "partial illumination" in Order Notes. Drawing required.
- Engineering validation required, longer lead times may apply.

# Ordering Guide Worksheet

Linear Circuitry, Zones & Factory Options



FOCAL POINT®

TOTAL RUN LENGTH: _____		JOB NAME: _____			FIXTURE TYPE: _____			
HOUSING SECTION	SECTION LENGTH	SHARED ELECTRICAL FEED, NORMAL POWER			FACTORY OPTIONS			EM
		SWITCHING CIRCUIT	DIMMING ZONE	DAYLIGHT ZONE	SEPARATE ELECTRICAL FEEDS			
DAYLIGHT CIRCUIT	EMERGENCY CIRCUIT				ECD			
1								
2								
3								
4								
5								
6								
7								
8								
9								
10								
11								
12								
13								
14								
15								
16								
17								
18								
19								
20								
<b>Totals / Ordering Codes</b>								

WORKSHEET

Combine to create Circuits & Zones ordering code

Enter as individual Factory Options

## RUN CHART

Run length (ft)	Housing Configuration Section Lengths	Run length (ft)	Housing Configuration Section Lengths	Run length (ft)	Housing Configuration Section Lengths	Run length (ft)	Housing Configuration Section Lengths
9	5 + 4	21	8 + 8 + 5	33	8 + 8 + 8 + 5 + 4	45	8 + 8 + 8 + 8 + 8 + 5
10	6 + 4	22	8 + 8 + 6	34	8 + 8 + 8 + 6 + 4	46	8 + 8 + 8 + 8 + 8 + 6
11	7 + 4	23	8 + 8 + 7	35	8 + 8 + 8 + 7 + 4	47	8 + 8 + 8 + 8 + 8 + 7
12	8 + 4	24	8 + 8 + 8	36	8 + 8 + 8 + 8 + 4	48	8 + 8 + 8 + 8 + 8 + 8
13	8 + 5	25	8 + 8 + 5 + 4	37	8 + 8 + 8 + 8 + 5		
14	8 + 6	26	8 + 8 + 6 + 4	38	8 + 8 + 8 + 8 + 6		
15	8 + 7	27	8 + 8 + 7 + 4	39	8 + 8 + 8 + 8 + 7		
16	8 + 8	28	8 + 8 + 8 + 4	40	8 + 8 + 8 + 8 + 8		
17	8 + 5 + 4	29	8 + 8 + 8 + 5	41	8 + 8 + 8 + 8 + 5 + 4		
18	8 + 6 + 4	30	8 + 8 + 8 + 6	42	8 + 8 + 8 + 8 + 6 + 4		
19	8 + 7 + 4	31	8 + 8 + 8 + 7	43	8 + 8 + 8 + 8 + 7 + 4		
20	8 + 8 + 4	32	8 + 8 + 8 + 8	44	8 + 8 + 8 + 8 + 8 + 4		

Standard run configurations, consult factory for custom configurations.